

Section #3 Pictorial Table Of Contents

Introduction To
80/20® Fasteners



Pages 222-223

How To
Order



Page 224

Fractional
Fastener Standards



Page 225

Fastener Tool
Size Reference



Page 225

Slide-In
Economy T-Nuts



Page 226

Double Slide-In
Economy T-Nuts



Page 227

Triple Slide-In
Economy T-Nuts



Page 228

Economy T-Nut
Holding Springs



Page 229

Slide-In Economy
T-Slot Studs



Page 229

Slide-In T-Nuts

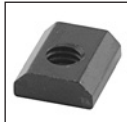

Page 230

Slide-In T-Nuts
with Ball Spring



Page 231

Slide-In T-Nuts
with Ball Spring



Page 231

Slide-In
T-Nuts



Page 232

Economy
Slide-In T-Nuts



Page 232

Roll-In T-Nuts
with Flex Handle



Page 233

Roll-In T-Nuts
with Set Screw



Page 234

Roll-In T-Nuts
with Ball Spring



Page 235

Roll-In T-Nuts
with Ball Spring



Page 236

Roll-In T-Nuts
with Spring Leaf



Page 237

Roll-In T-Nuts
with Spring Leaf



Page 238

Drop-In T-Nuts



Page 238

Drop-In
T-Nuts



Page 239

Drop-In
T-Studs



Page 240

Hidden Corner
Connectors



Page 241

Anchor
Fasteners



Page 242

Double Anchor
Fasteners



Page 243

Butt Fasteners



Page 244

Central
Connectors



Page 244

Standard
End Fasteners



Page 245

Double
End Fasteners



Page 246

Single Tab
End Fasteners



Page 246

Miter
Connector



Page 247

90° Inside
Corner Connector



Page 248

Bolt Assemblies
& Components



Pages 249-259

Legend for Icons



This part is
10 Series compatible

80/20® Inc.

The Industrial Erector Set®

THE STANDARD

Introduction to Fasteners

80/20® has the largest assortment of fasteners available in the industry! We stock over 20 types, featuring over 400 variations and combinations for your applications. 80/20 fasteners are made of high-quality materials and hold tight tolerances. Variations include fasteners that load from the profile end or the profile side, fractional or metric, and black zinc, bright zinc or stainless steel material.

Slide-In Economy T-Nuts: single economy T-nuts are available with the thread centered or offset to best fit your application requirements. Offset T-nuts are ideal for making clean end connections without compromising strength. Centered T-nuts work well for connections made in the center of a profile or with a joining plate. Economy T-nuts are also available in double and triple configurations.

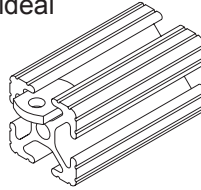

Standard **Slide-In T-Nuts**, made of 1215 carbon steel, are high-strength, low-cost fasteners that load from the profile end. They can be customized up to 36 inches in length for any application.

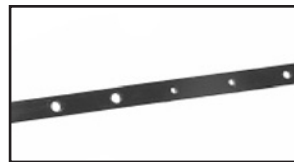

Customized Lengths Available

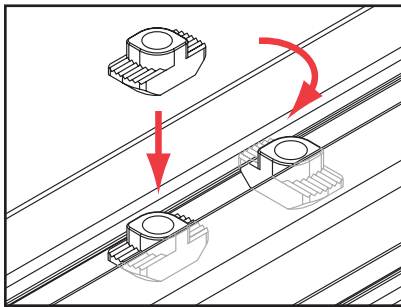
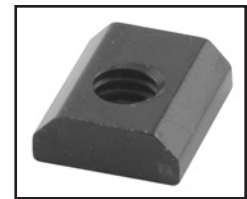

Drop-in T-Nut fasteners are a cost-effective, modular choice for most mounting needs. If the profile ends are captivated, drop-in fasteners can be placed directly in the T-slot, then rotated for secure placement.



End Fasteners provide a strong, square, hidden joint in a fixed location that simplifies assembly. When ordering applications with end fasteners, be sure to specify tapping and access hole machining services for your profiles.

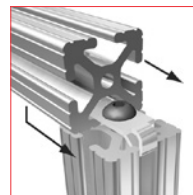
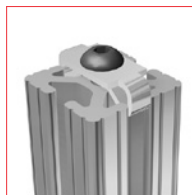

Self-Aligning T-Nuts have a raised section that extends up into the T-slot opening. This feature will center the threaded hole of the T-nut in the T-slot, prevent rotation and allow for longer thread dimensions. **Note:** Make certain the "neck" does not extend past the face of the T-slot profile, interfering with the connection.

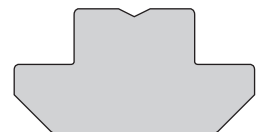

Fractional

Roll-In T-Nuts with Flex Handle, Set Screw, Ball Spring or Spring Leaf load from the profile side, allowing add-ons to your application without dismantling the frame. Roll-in T-nuts with a flex handle, ball spring, set screw or spring leaf hold the T-nut in place for easy positioning. The flex handle makes removal of the drop-in simple.

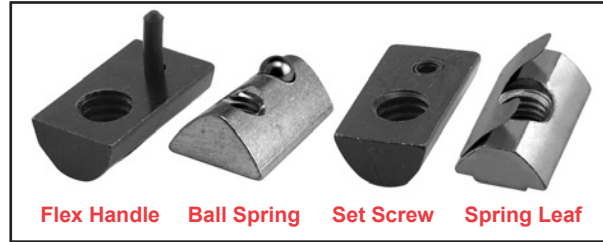
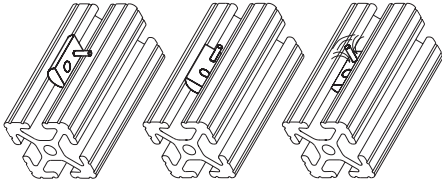

Slide-In Economy T-Slot Studs, loaded from the end of a profile, are the strongest fastener available from 80/20® for use with joining plates. By engaging the Drop-Lock feature, they provide a vibration-proof connection when properly tightened. The square key on the shoulder of the bolt prevents the stud from turning when an application is subjected to vibration.



Drop-in T-Slot Studs

load from the profile end or into the profile side. If the profile ends are captivated, drop-in fasteners can be placed directly in the T-slot, then rotated for secure placement.

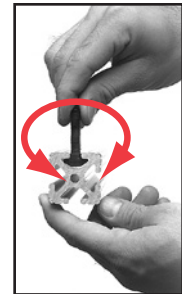
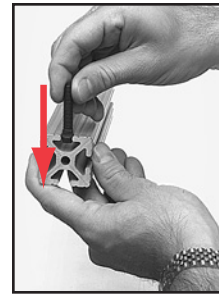

Anchor Fasteners, available in single and double configurations, are perfect for making 90° connections in the center of a bar. These fasteners make a strong, flush connection that can be easily adjusted when used with any of 80/20®'s T-slotted profiles.

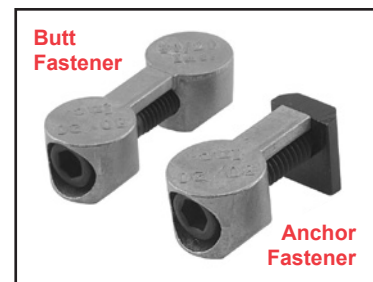
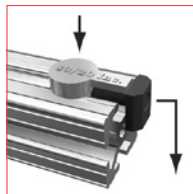

Butt Fasteners allow you to fasten two profiles end-to-end with maximum strength and near-perfect alignment. When space restrictions prevent the use of joining plates, butt fasteners are the perfect solution.

80/20® Inc.

The Industrial Erector Set®

THE STANDARD**How to Order 80/20® Fasteners**

As you will notice in the order example below, ordering fasteners from 80/20® is a simple process. Simply write the part number and quantity required (note: when ordering bolt kits, double check the quantity required per the connector). To finish, just write a brief description of the fastener you are ordering. This will help us ensure that you receive the exact parts you need.

How To Order

Shipping Method: Ship To: _____

Ordered By: Customer: _____

Address: _____

City / State: _____

Attention: _____

Tag: _____

Complete Address & Shipping Method Required... NO P.O. Box

Part Number	Quantity	Length	Description / Machining	Price/ UOM	Ext. Price
1010	2	18.50"	7042 in A both ends	\$.23	\$8.51
1515-Lite-145	5	145.00"	Full length profile	\$65.25	\$326.25
3060	4	40.00"	7029 one end	\$2.95	\$472.00
3030	4	36.00"	7050 style G in W, X both ends	\$1.50	\$216.00
CM01-051006	2		Custom bracket per drawing #1	\$23.00	\$46.00
2611	1	5.25 sf.	1/4" bronze polycarb 1 @ 18" x 40" w/ 7311 per drawing	\$10.40	\$54.60
7150	1		Cut plastic panels all sides < -48"	\$10.50	\$10.50
7042	4		10 Series anchor fastener counterbore	\$2.25	\$9.00
7005	2		Cut-to-length for 1010	\$1.95	\$3.90
7023	4		Cut-to-length for 3060	\$2.90	\$11.60
7030	4		Cut-to-length for 3030	\$2.60	\$10.40
7050	64		15 Series drill access hole	\$1.95	\$124.80
7029	4		5/16-18 tap service for 3060	\$15.20	\$60.80
7311	2		Anchor fastener notch for 10 Series	\$0.53	\$1.06
3380	32		15 Series 5/16-18 black zinc end fastener w/ screw	\$1.60	\$51.20
2114	16		Gray T-Slot covers for 10 Series	\$3.45	\$55.20
2050	8		End caps for 3030	\$1.85	\$14.80
3395	4		10 Series anchor fasteners	\$2.90	\$11.60
3279	5		15 Series 5/16-18 black zinc double economy T-nut	\$0.79	\$3.95
4132	12		2 hole inside corner gusset bracket	\$3.95	\$47.40
3393	24		10 Series 1/4-20 BHSCS & economy T-nut	\$0.40	\$9.60
TOTAL					\$1549.17

Special Instructions: **Must be delivered for assembly by Friday!!!**

NOTE: Prices shown for illustration use only.
Contact your distributor for a personalized quote.

- 1 - Profiles = Pages 147-202 • 2 - Custom Parts = Pages 203-220 • 3 - Panels = Pages 349-432
4 - Machining Services = Pages 559-608 • 5 - Accessories & Tools = Pages 433-456 & 549-558

Fastener Standards

Assembling T-slotted profiles with 80/20®'s selection of fasteners is a simple and quick process. To ensure a secure connection, there are a few key points to keep in mind when placing fasteners into the T-slot:

Threaded Pilot Projection

The threaded pilot projection on T-nuts exists to provide more thread, adding strength to the fastener. Always aim the projection down in the T-slot to avoid crashing and an uneven connection.

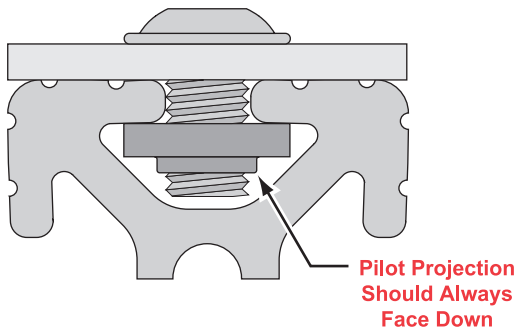

Offset Tap Hole Location

The offset threaded hole on 80/20® T-nuts allows for a flush surface when mating two profiles at a 90° connection. This is most common when using anchor fasteners, as shown in the example below.

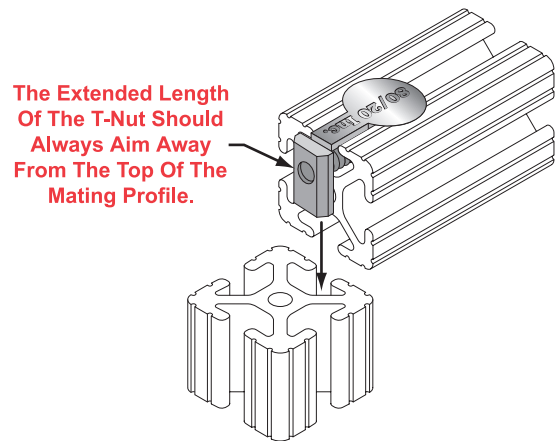

Fastener Hex Tool Size Reference

This chart is a quick reference when looking for the correct size of hex wrench to use with 80/20® fasteners. See pages 549-558 for power bits, T or L handle wrenches, and Bondhus® tools.

Thread Size	Fastener Head			
	SHCS	BHSCS	FBHSCS	FHSCS
8-32	N/A	3/32"	N/A	N/A
10-32	5/32"	1/8"	N/A	N/A
1/4-20	3/16"	5/32"	5/32"	5/32"
5/16-18	1/4"	3/16"	3/16"	3/16"
3/8-16	5/16"	N/A	N/A	7/32"
M5	4mm	3mm	N/A	3mm
M6	5mm	4mm	N/A	4mm
M8	6mm	5mm	N/A	5mm
M10	8mm	6mm	N/A	6mm

80/20® Inc.

The Industrial Erector Set®

THE STANDARD

Slide-In Economy T-Nuts

- Loads from the profile end only
- Available in stainless steel or carbon steel, black or bright zinc-plated
- Refer to pages 249-259 for our full screw and bolt offering

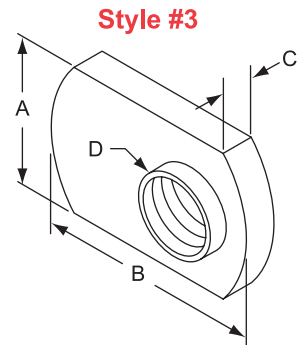
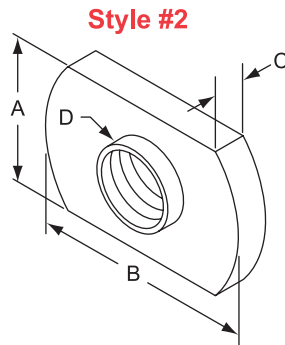
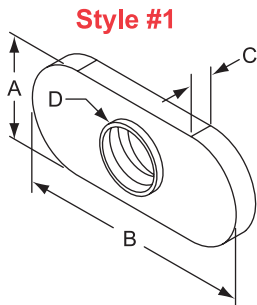

3

Part No.	Nut Style	A	B	C	D (Thread)	Finish	Lbs.
3275	Style 1	.443	.875	.094	8-32 Centered	Black Zinc	.008
3276	Style 1	.443	.875	.094	10-32 Centered	Black Zinc	.008
3675	Style 1	.443	1.000	.094	1/4-20 Centered	Stainless Steel	.009
3382	Style 1	.443	1.000	.094	1/4-20 Centered	Black Zinc	.009
3785	Style 1	.443	1.000	.094	1/4-20 Centered	Bright Zinc	.009
3859	Style 1	.443	1.000	.094	M6 x 1.0 Centered	Bright Zinc	.010
3686	Style 2	.505	.812	.125	1/4-20 Centered	Stainless Steel	.012
3286	Style 2	.505	.812	.125	1/4-20 Centered	Black Zinc	.012
3786	Style 2	.505	.812	.125	1/4-20 Centered	Bright Zinc	.012
3836	Style 2	.505	1.125	.125	M6 x 1.0 Centered	Bright Zinc	.017
3676	Style 3	.380	.625	.094	10-32 Offset	Stainless Steel	.005
3278	Style 3	.637	.984	.142	5/16-18 Offset	Black Zinc	.021
3778	Style 3	.637	.984	.142	5/16-18 Offset	Bright Zinc	.021
3838	Style 3	.630	.984	.142	M8 x 1.25 Offset	Bright Zinc	.021
3678	Style 3	.637	1.125	.142	5/16-18 Offset	Stainless Steel	.024

☒ = 10 Series Compatible Part

Threaded Pilot Projection

The threaded pilot projection provides more thread, adding strength to the fastener. Always position the projection down in the T-slot to avoid crashing and an uneven connection.

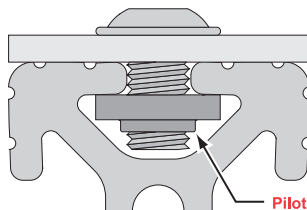

Pilot Projection
Should Always
Face Down

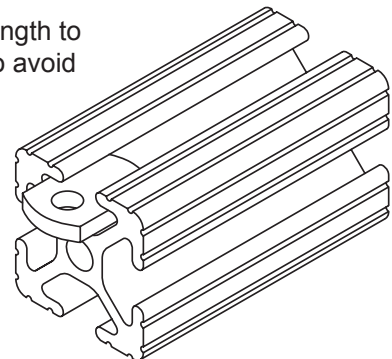

Fractional

Double Slide-In Economy T-Nuts

- Reduces assembly time
- Loads from the profile end only
- Perfect for multiple hole joining plates
- Made from steel with bright and black zinc finishes
- Refer to pages 249-259 for our full screw and bolt offering

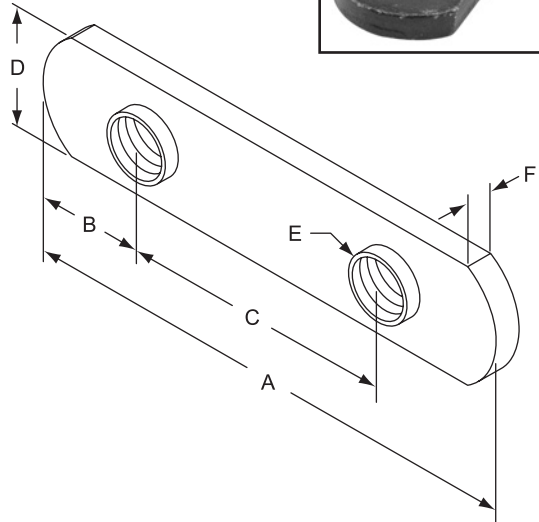
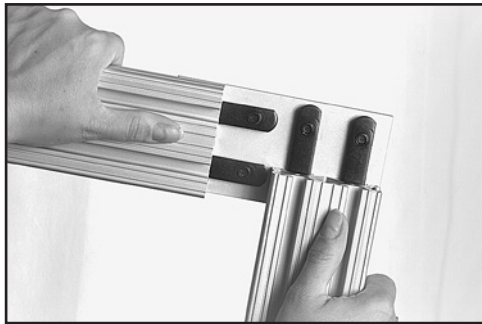
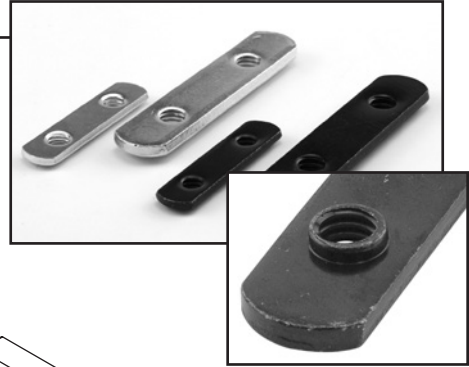

Part No.	A	B	C	D	E (Thread)	F	Finish	Lbs.
3281 ☒	1.375	.187	1.000	.443	8-32	.095	Black Zinc	.019
3280 ☒	1.875	.443	1.000	.443	1/4-20	.095	Black Zinc	.012
3800 ☒	1.870	.443	1.000	.443	M6 x 1.00	.095	Bright Zinc	.012
3279	2.810	.655	1.500	.625	5/16-18	.142	Black Zinc	.063
3879	3.000	.750	1.500	.625	M8 x 1.25	.142	Bright Zinc	.063

☒ = 10 Series Compatible Part

Threaded Pilot Projection

The threaded pilot projection provides more thread, adding strength to the fastener. Always position the projection down in the T-slot to avoid crashing and an uneven connection.

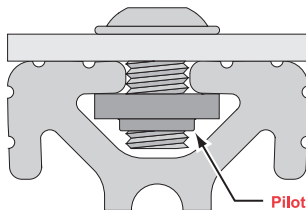

Pilot Projection
Should Always
Face Down

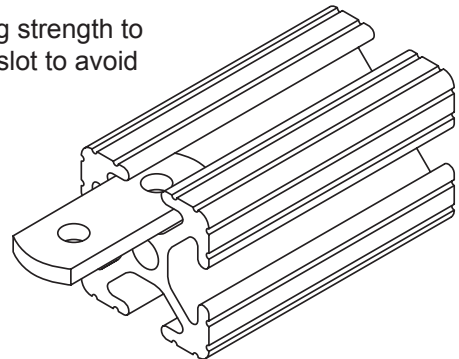

80/20® Inc.

The Industrial Erector Set®

THE STANDARD**Triple Slide-In Economy T-Nuts**

- Reduces assembly time
- Loads from the profile end only
- Made from steel with bright and black zinc finishes
- Perfect for multiple hole joining plates
- Refer to pages 249-259 for our full screw and bolt offering

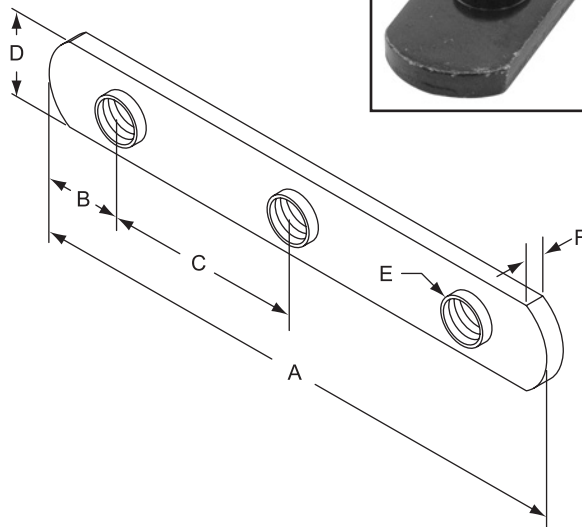
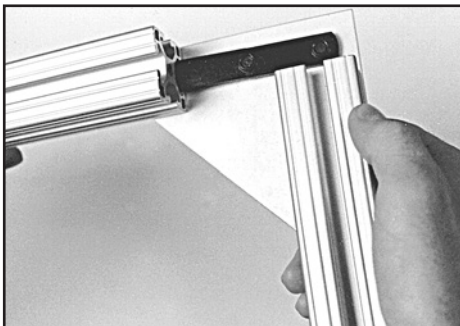
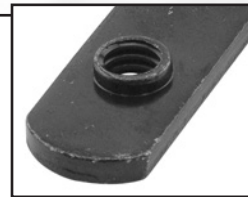

Part No.	A	B	C	D	E (Thread)	F	Finish	Lbs.
3287 ☒	2.450	.241	1.000	.440	1/4-20	.095	Black Zinc	.019
3900 ☒	2.450	.241	1.000	.440	M6 x 1.00	.095	Bright Zinc	.020
3285	3.560	.296	1.500	.625	5/16-18	.142	Black Zinc	.063
3805	3.560	.296	1.500	.625	M8 x 1.25	.142	Bright Zinc	.063

☒ = 10 Series Compatible Part

Threaded Pilot Projection

The threaded pilot projection provides more thread, adding strength to the fastener. Always position the projection down in the T-slot to avoid crashing and an uneven connection.

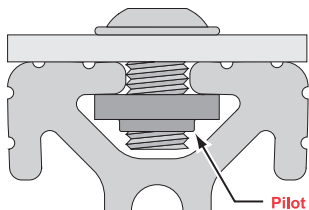

Pilot Projection
Should Always
Face Down

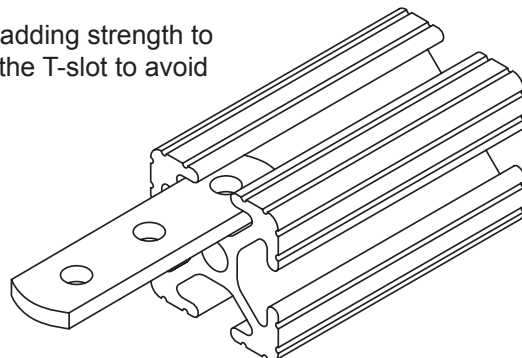

Fractional

Economy T-Nut Holding Springs

- Holds 15 Series 5/16-18 or M8 x 1.25 slide-in economy T-nuts in place
- Snaps around the pilot projection of the T-nut
- Sold in bags of 100 springs
- Compatible with 3278, 3279, 3285, 3678, 3778, 3805, 3838, and 3879

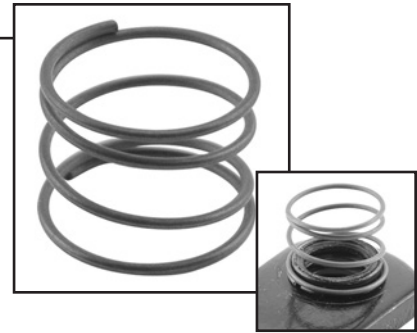

Part No.	Compatible Series	Lbs. (bag)
3010	15 Series & 40 Series	.100

Slide-In Economy T-Slot Studs

- 15 Series compatible
- Loads from the profile end only
- Strongest fastener available for joining plates
- Square neck prevents rotation
- Refer to pages 249-259 for our full nut and washer offering



Part No.	Finish	Thread x Length	Lbs.
3116	SAE Grade 5 Black Zinc Finish	5/16-18 x .75"	.026
3851	SAE Grade 2 Bright Zinc Finish	M8 x 20mm	.031
3120	SAE Grade 5 Black Zinc Finish	5/16-18 x 1.00"	.031
3852	SAE Grade 2 Bright Zinc Finish	M8 x 25mm	.034
3126	SAE Grade 5 Black Zinc Finish	5/16-18 x 1.25"	.035
3853	SAE Grade 2 Bright Zinc Finish	M8 x 30mm	.037
3134	SAE Grade 5 Black Zinc Finish	5/16-18 x 1.50"	.039
3854	SAE Grade 2 Bright Zinc Finish	M8 x 35mm	.043
3288	SAE Grade 5 Black Zinc Finish	5/16-18 x 1.75"	.045
3857	SAE Grade 2 Bright Zinc Finish	M8 x 45mm	.047
3290	SAE Grade 5 Black Zinc Finish	5/16-18 x 2.00"	.050

80/20® Inc.

The Industrial Erector Set®

THE STANDARD**Slide-In T-Nuts**

- Loads from the profile end only
- Made from 1215 carbon steel with bright and black zinc finishes
- Up to 36" standard T-nut lengths are available for customized T-nut hole configuration*
- Refer to pages 249-259 for our full screw and bolt offering
- See page 563 for cut-to-length, Part No. 7212.

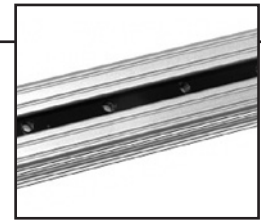
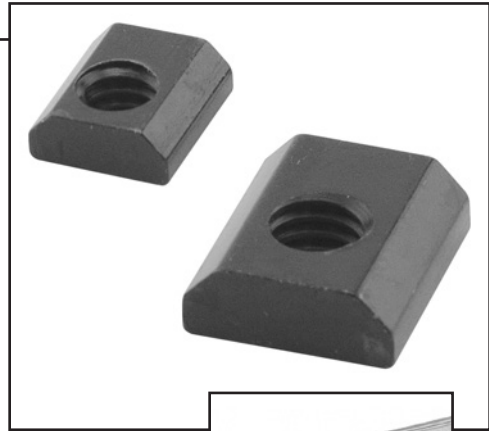

Customized Lengths Available

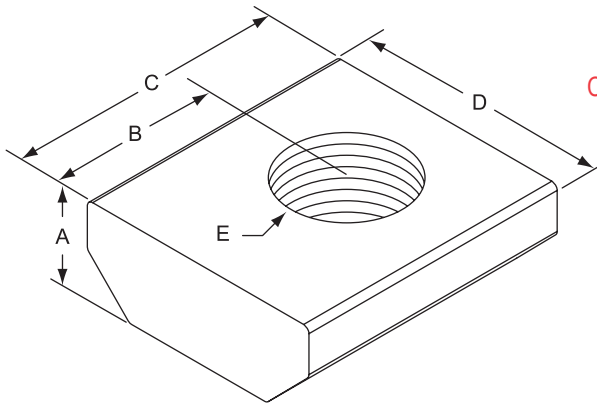

3

Part No.	A	B (Tap Location)	C	D	E (Thread)	Finish	Lbs.
3205 ☒	.171	.200	.490	.431	10-32	Black Zinc	.010
3204 ☒	.171	.200	.490	.431	1/4-20	Black Zinc	.010
3206 ☒	.171	.200	.490	.431	M5 x .80	Black Zinc	.010
3871 ☒	.171	.200	.490	.431	M5 x .80	Bright Zinc	.010
3873 ☒	.171	.200	.490	.431	M6 x 1.00	Bright Zinc	.010
8901 ☒	.171	Per your Drawing	Per your Drawing	.431	Per your Drawing	Per your Drawing	.230 / Ft.
8901-36 ☒	.171	N/A	36.000	.431	N/A	Black or Bright Zinc	.690
3201	.250	.281	.687	.625	10-32	Black Zinc	.020
3202	.250	.281	.687	.625	1/4-20	Black Zinc	.020
3203	.250	.281	.687	.625	5/16-18	Black Zinc	.020
3866	.250	.281	.687	.625	M6 x 1.00	Bright Zinc	.020
3703	.250	.281	.687	.625	5/16-18	Bright Zinc	.020
3868	.250	.281	.687	.625	M8 x 1.25	Bright Zinc	.020
8900	.250	Per your Drawing	Per your Drawing	.625	Per your Drawing	Per your Drawing	.460 / Ft.
8900-36	.250	N/A	36.000	.625	N/A	Black or Bright Zinc	1.308

☒ = 10 Series Compatible Part

*Note: 80/20® can customize T-nut profiles to match your specific requirements; simply submit a sketch to 80/20® or your distributor.

Fractional

Slide-In T-Nuts with Ball Spring Steel, Zinc-Plated, Self-Aligning

- Loads from the profile end only
- Compatible with 15 and 40 Series profiles
- Ball spring positions the T-nut in the slot for easier assembly

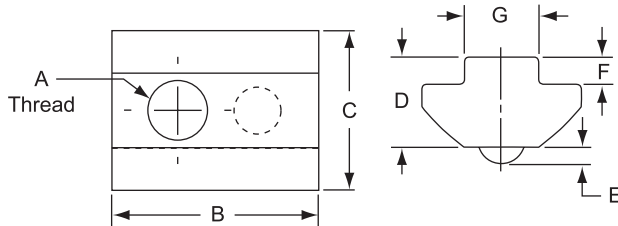
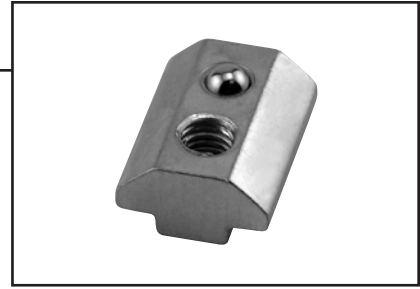

Part No.	A	B	C	D	E	F	G	Lbs.	Compatibility Code*
13050	M4	.866	.669	.378	.067	.114	.315	.024	8-15 8-40
13051	M5							.023	
13052	M6							.022	
13053	M8							.020	
13054	1/4-20							.022	
13055	5/16-18							.020	

Slide-In T-Nuts with Ball Spring Steel, Zinc-Plated

- Loads from the profile end only
- Compatible with 15 and 40 Series profiles

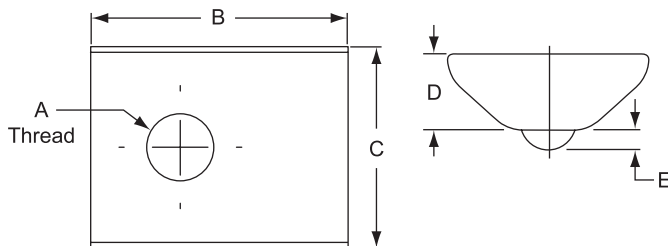
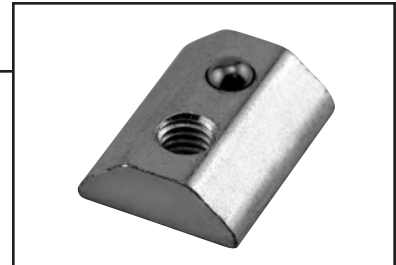

Part No.	A	B	C	D	E	Lbs.	Compatibility Code*
13064	M5	.905	.709	.268	.067	.036	8-15 8-40
13065	M6					.035	
13066	M8					.033	

* See Compatibility Code information on page 152.

80/20® Inc.

The Industrial Erector Set®

THE STANDARD**Slide-In T-Nuts**

Steel, Zinc-Plated, Self-Aligning

- Loads only from the profile end
- Compatible with 15, 30 and 40 Series profiles

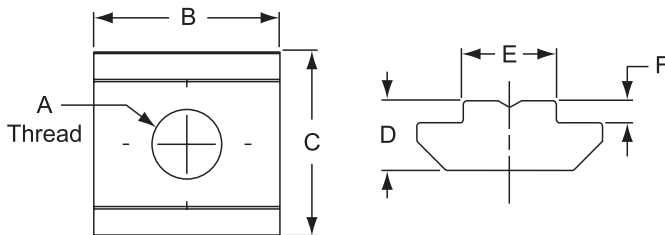

Part No.	A	B	C	D	E	F	Lbs.	Compatibility Code*
13022	M4	.630	.630	.236	.315	.075	.019	8-15
13023	M5						.018	8-30
13024	M6						.017	8-40
13025	M8						.015	

3

Slide-In Economy T-Nuts

Steel, Zinc-Plated

- Loads only from the profile end
- Very economical
- Low profile

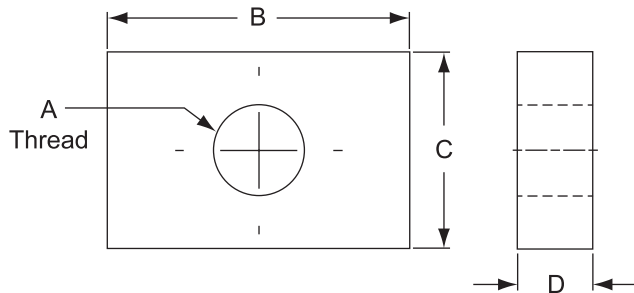
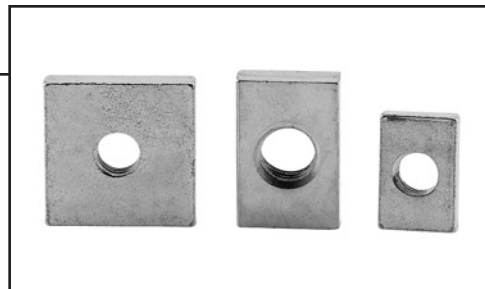

Part No.	A	B	C	D	Compatibility Code*
14124	M6	.590	.394	.157	6-10, 6-25
14126	M6	.748	.630	.157	8-15, 8-40, 10-45
14127	M8	.748	.630	.157	8-15, 8-40, 10-45
14130	M6	.787	.512	.197	8-15, 8-40, 10-45
14131	M8	.787	.512	.197	8-15, 8-40, 10-45

* See Compatibility Code information on page 152.

Fractional

Roll-In T-Nuts with Flex Handle

- Easy to add and reposition on existing frame where T-slot ends are captivated
- Can be loaded from the profile end or the profile side
- Rubber friction nub holds nut in vertical position in the T-slot
- This high strength T-nut reduces assembly time and can be easily removed from the T-slot
- Refer to pages 249-259 for our full screw and bolt offering

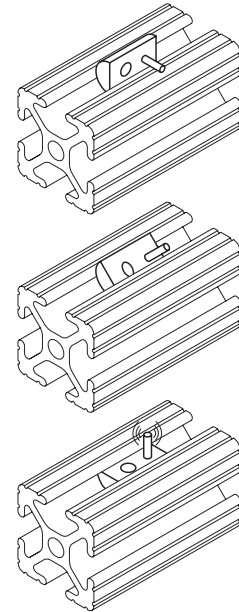
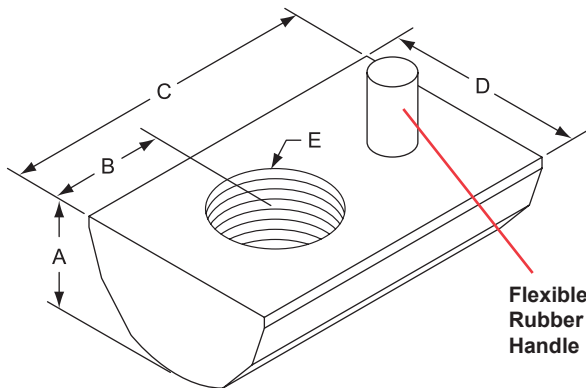

Part No.	A	B (Tap Location)	C	D	E (Thread)	Finish	Lbs.
3375 ☒	.200	.201	.620	.395	10-32	Black Zinc	.009
3790 ☒	.200	.201	.620	.395	10-32	Bright Zinc	.009
3376 ☒	.200	.201	.620	.395	1/4-20	Black Zinc	.008
3624 ☒	.200	.201	.620	.395	1/4-20	Stainless Steel	.008
3791 ☒	.200	.201	.620	.395	1/4-20	Bright Zinc	.009
3875 ☒	.200	.201	.620	.395	M5 x .80	Bright Zinc	.010
3876 ☒	.200	.201	.620	.395	M6 x 1.00	Bright Zinc	.008
3284	.285	.310	.875	.510	10-32	Black Zinc	.026
3784	.285	.310	.875	.510	10-32	Bright Zinc	.026
3283	.285	.310	.875	.510	1/4-20	Black Zinc	.024
3783	.285	.310	.875	.510	1/4-20	Bright Zinc	.025
3843	.285	.310	.875	.510	M6 x 1.00	Bright Zinc	.023
3282	.285	.310	.875	.510	5/16-18	Black Zinc	.023
3782	.285	.310	.875	.510	5/16-18	Bright Zinc	.023
3842	.285	.310	.875	.510	M8 x 1.25	Bright Zinc	.023
3602	.285	.310	.875	.510	1/4-20	Stainless Steel	.022
3600	.285	.310	.875	.510	5/16-18	Stainless Steel	.023

☒ = 10 Series Compatible Part

80/20® Inc.

The Industrial Erector Set®

THE STANDARD**Roll-In T-Nuts with Set Screw**

- Easy to add and reposition to an existing frame where T-slot ends are captivated
- Can be loaded from the profile end or the profile side
- The set screw permanently positions the T-nut in the T-slot*
- Available in black and bright zinc as well as stainless steel
- Refer to pages 249-259 for our full screw and bolt offering

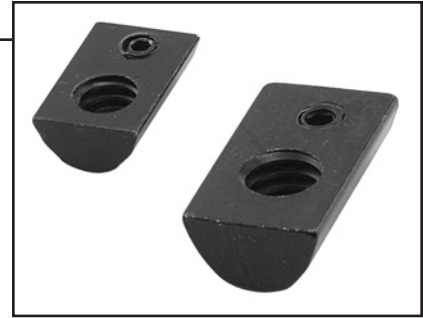

*Note: An "L" wrench or a Bondhus® Combo Tool, shown in Section 11, is required for adjusting the set screw.

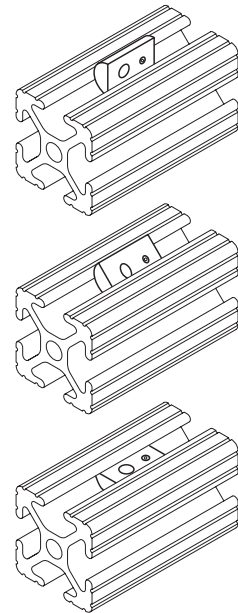
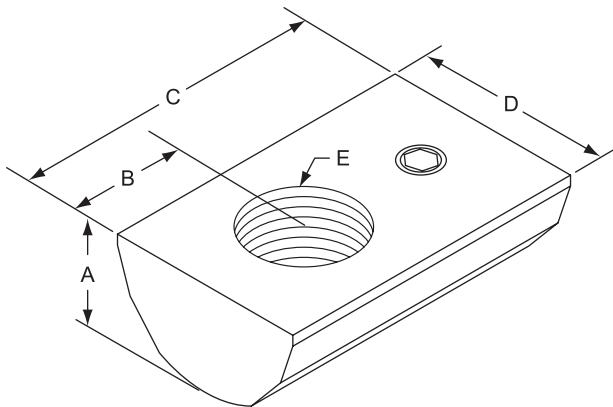

3

Part No.	A	(B) Tap Location	C	D	E (Thread)	Set Screw Thread	Hex Wrench Size	Finish	Lbs.
3312 ☒	.200	.201	.620	.395	10-32	6-32	1/16	Black Zinc	.008
3313 ☒	.200	.201	.620	.395	1/4-20	6-32	1/16	Black Zinc	.008
3309	.285	.310	.875	.510	10-32	10-24	3/32	Black Zinc	.029
3310	.285	.310	.875	.510	1/4-20	10-24	3/32	Black Zinc	.027
3311	.285	.310	.875	.510	5/16-18	10-24	3/32	Black Zinc	.026
3605	.285	.310	.875	.510	1/4-20	10-24	3/32	Stainless Steel	.027
3608	.285	.310	.875	.510	5/16-18	10-24	3/32	Stainless Steel	.026
3781	.285	.310	.875	.510	10-32	10-24	3/32	Bright Zinc	.029
3787	.285	.310	.875	.510	1/4-20	10-24	3/32	Bright Zinc	.028
3788	.285	.310	.875	.510	5/16-18	10-24	3/32	Bright Zinc	.026
3892	.285	.310	.875	.510	M5 x 0.80	M5	2.5MM	Bright Zinc	.029
3894	.285	.310	.875	.510	M8 x 1.25	M5	2.5MM	Bright Zinc	.025
3898	.285	.310	.875	.510	M6 x 1.00	M5	2.5MM	Bright Zinc	.026

☒ = 10 Series Compatible Part

Fractional

Roll-In T-Nuts with Ball Spring

- 10, 15, 25 and 40 Series compatible
- Easy to add and reposition to existing frame where T-slot ends are captivated
- Can be loaded from the profile end or the profile side
- The ball spring holds the T-nut in vertical position in the T-slot
- Refer to pages 249-259 for our full screw and bolt offering



NEW! Now available for 10 Series

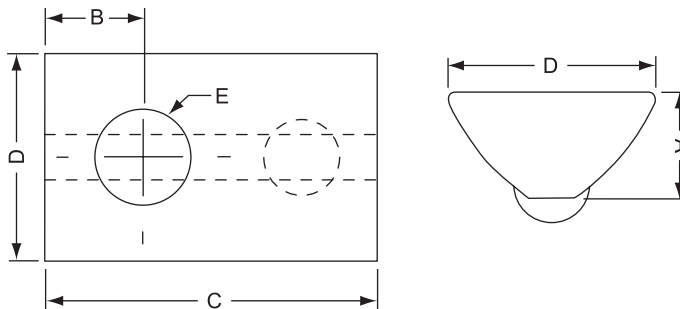

Part No.	A	B (Tap Location)	C	D	E (Thread)	Finish	Lbs.
3913	.276	.276	.866	.539	M5	Bright Zinc	.028
3914	.276	.276	.866	.539	M6	Bright Zinc	.026
3915	.276	.276	.866	.539	M8	Bright Zinc	.026
3916	.276	.276	.866	.539	1/4-20	Bright Zinc	.028
3917	.276	.276	.866	.539	5/16-18	Bright Zinc	.026
3919	.200	.200	.620	.395	M4	Bright Zinc	.0098
3920	.200	.200	.620	.395	M5	Bright Zinc	.0094
3921	.200	.200	.620	.395	M6	Bright Zinc	.0084
3922	.200	.200	.620	.395	10-32	Bright Zinc	.0092
3923	.200	.200	.620	.395	1/4-20	Bright Zinc	.0084
3666	.200	.200	.620	.395	M4	Stainless Steel	.0084
3667	.200	.200	.620	.395	M5	Stainless Steel	.0094
3668	.200	.200	.620	.395	M6	Stainless Steel	.0088
3669	.200	.200	.620	.395	10-32	Stainless Steel	.0096
3670	.200	.200	.620	.395	1/4-20	Stainless Steel	.0086
13018	.275	.255	.866	.539	1/4-20	Stainless Steel	.022
13021	.275	.255	.866	.539	5/16-18	Stainless Steel	.020

80/20[®] Inc.

The Industrial Erector Set[®]

THE STANDARD

Roll-In T-Nuts with Ball Spring Steel & Stainless Steel, Self-Aligning

- T-nut can be loaded from the profile end or side
- Ball spring positions the T-nut in the slot for easier assembly
- Use in 15 and 40 Series profiles

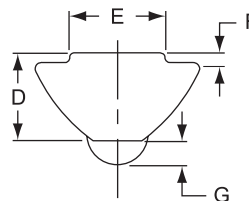
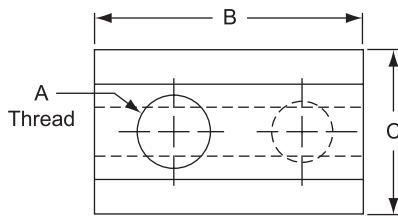

Part No.	Material	A	B	C	D	E	F	G	Lbs.	Compatibility Code*
13027	Steel, Zinc-Plated	M4	.866	.531	.283	.307	.031	.067	.024	8-15 8-40
13028		M5							.023	
13031		M6							.022	
13034		M8							.020	
13039		10-32							.024	
13037		1/4-20							.022	
13040	5/16-18	.021	Stainless Steel	M5	.023	.022	.020			
13029	M5	.023								
13032	M6	.022								
13035	M8	.020								

Fractional

Roll-In T-Nuts

Steel, Zinc-Plated, Self-Aligning

- Loads from the profile end or side
- Use in 15, 30 and 40 Series profiles

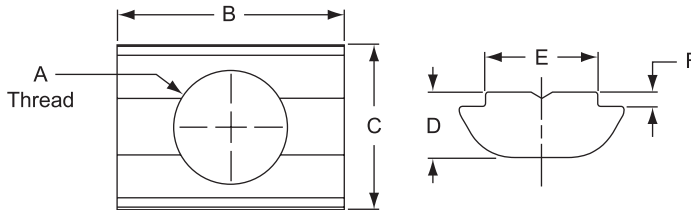
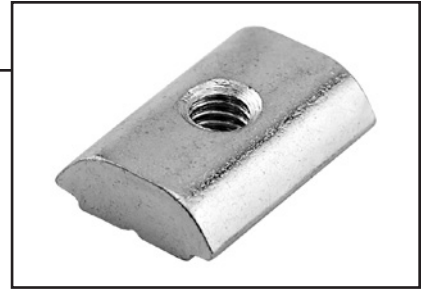

Part No.	A	B	C	D	E	F	Lbs.	Compatibility Code*
13088	M4	.630	.457	.181	.311	.039	.009	8-15 8-30 8-40
13090	M5						.008	
13092	M6						.007	
13094	M8						.006	
13096	1/4-20						.010	
13098	5/16-18						.008	

Roll-In T-Nuts with Spring Leaf

Steel, Zinc-Plated, Self-Aligning

- Loads from the profile end or side
- Spring leaf positions the T-nut in the slot for easier assembly
- Compatible with 15 and 40 Series profiles

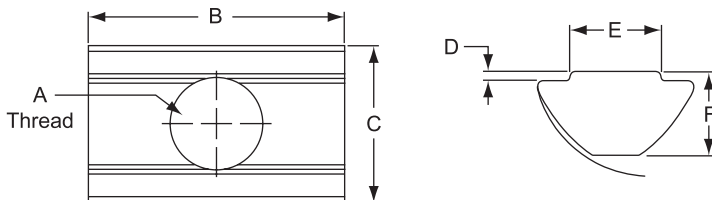
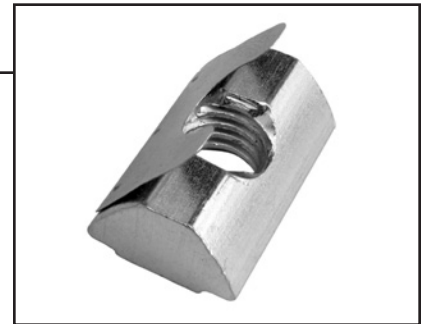

Part No.	A	B	C	D	E	F	Lbs.	Compatibility Code*
13030	M5	.866	.531	.031	.307	.283	.025	8-15 8-40
13033	M6						.024	
13036	M8						.022	
13038	1/4-20						.024	
13041	5/16-18						.022	

* See Compatibility Code information on page 152.

80/20® Inc.

The Industrial Erector Set®

THE STANDARD

Roll-In T-Nuts with Spring Leaf Steel, Zinc-Plated, Self-Aligning

- Loads from the profile end or side
- Spring leaf positions the T-nut in the slot for easier assembly
- Compatible with 15, 30 and 40 Series profiles

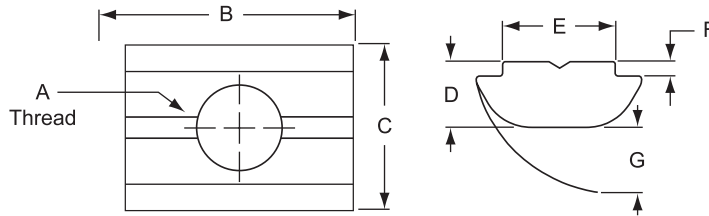
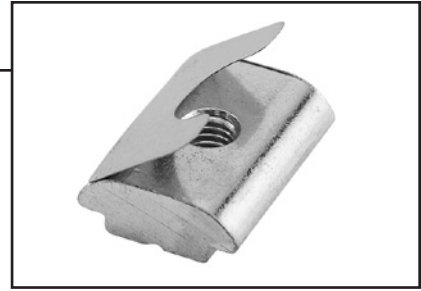

Part No.	A	B	C	D	E	F	G	Lbs.	Compatibility Code*	
13089	M4	.630	.457	.181	.311	.039	.205	.008	8-15	
13091	M5							.008		8-30
13093	M6							.007		
13095	M8							.007	8-40	

3

Drop-In T-Nuts Die-Cast Zinc

- Loads from the profile end or side
- Compatible with 15 and 40 Series profiles

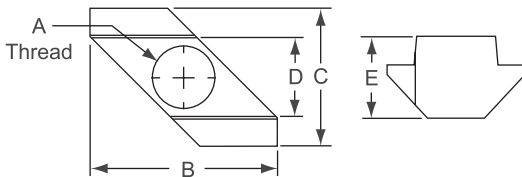
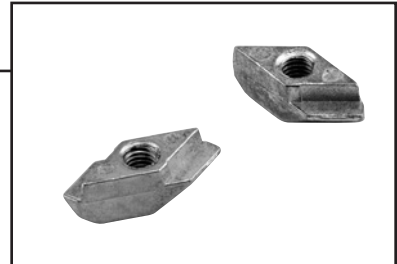

Part No.	A	B	C	D	E	Lbs.	Compatibility Code*
13179	M3	.748	.551	.315	.327	.011	8-15
13180	M4						
13181	M5						
13182	M6						
14161	1/4-20						

* See Compatibility Code information on page 152.

Fractional

Drop-In T-Nuts

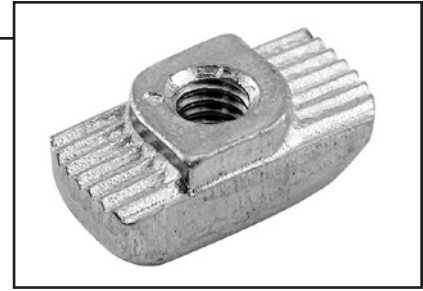
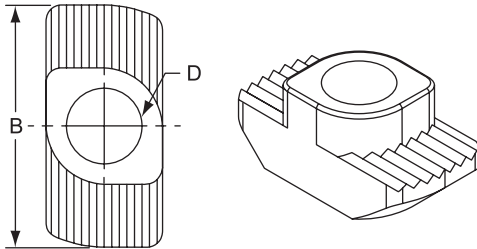
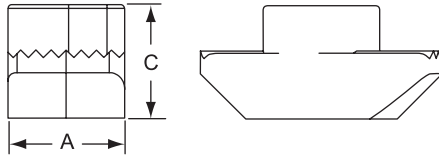

- 10, 15, 25 and 40 Series compatible
- Loads into the profile T-slot when ends are captivated
- Ridges bite into the profile surface maximizing the connection

Part No.	Material	A	B	C	D (Thread)	Lbs.	Compatibility Code*
3930	Zinc-Plated Steel	.310	.625	.250	M5	.007	8-15
3931					M6	.007	
3932					10-32	.007	6-10
3933					1/4-20	.007	
14162	Steel	.224	.453	.165	10-32	.003	6-10
14164					M4	.003	
14166	Stainless Steel				M4	.003	
13114	Zinc-Plated Steel	.303	.630	.295	M4	.010	8-15
13116					M5	.008	
13119					M6	.007	8-40
14165					1/4-20	.007	

* See Compatibility Code information on page 152.

CUSTOMIZE YOUR PROJECT WITH ANY OF THESE 80/20® ACCESSORIES

- End Caps - Pg. 436
- T-Slot Covers - Pg. 437
- Table Tops - Pg. 443
- Cart Guard® - Pg. 444-445
- AkroBins® - Pg. 446
- Bumpers - Pg. 448
- Tube Clamps - Pg. 440 & 450
- Wiring Duct - Pg. 439
- Tool Hangers - Pg. 447
- Document Holders - Pg. 449
- Pressure Manifolds - Pg. 451-453
- Custom designs to fit your space constraints
- Workstation & desk components to meet the demands of the job at hand
- Aesthetically pleasing
- End or side mounts for manifold plates, even CUSTOM plates (our specialty)
- Accessories to compliment your design even more
- **COLORS! COLORS! COLORS!**
- One-Stop Shopping!...only at 80/20

80/20[®] Inc.

The Industrial Erector Set[®]

THE STANDARD

Drop-In T-Studs Steel

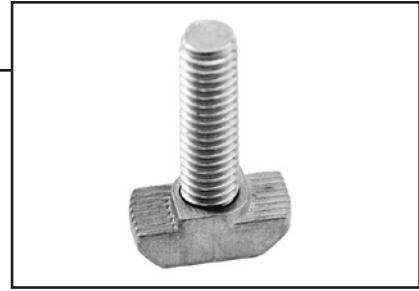
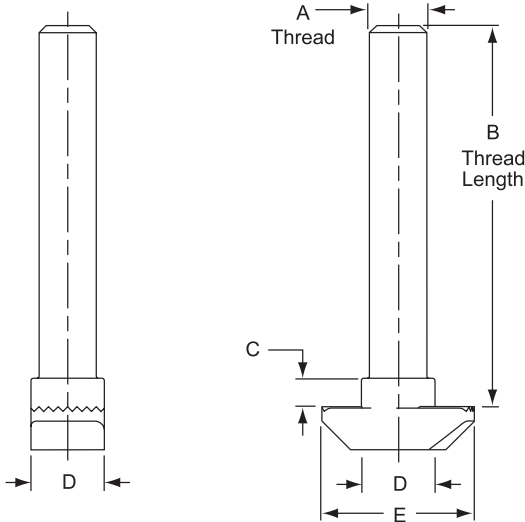

- 15 and 40 Series compatible
- Loads from the profile end or side

3

Part No.	Material	A	B	C	D	E	Lbs.	Compatibility Code*
13144	Zinc-Plated Steel	M6	.787	1.18	.303	.630	.012	8-15 8-40
13145			.984				.014	
13146			1.181				.018	
13147			1.575				.022	
13148			2.362				.028	

Drop-In T-Slot Studs

- 15 Series compatible
- Loads from the profile end or into the profile side when both ends are captivated
- Neck engages in T-slot opening, preventing rotation.
- Refer to pages 249-259 for our full nut and washer offering

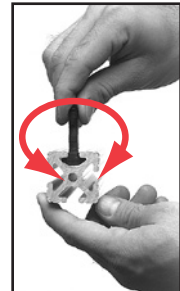
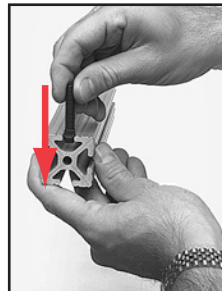

Part No.	Finish	Thread x Length	Lbs.
3293	SAE Grade 5 Black Zinc Finish	5/16-18 x 3/4"	.023
3295	SAE Grade 5 Black Zinc Finish	5/16-18 x 1"	.027
3297	SAE Grade 5 Black Zinc Finish	5/16-18 x 1-1/4"	.032
3299	SAE Grade 5 Black Zinc Finish	5/16-18 x 1-1/2"	.036

Fractional

Hidden Corner Connectors

- Die-cast zinc, clear finish
- Provides a hidden 90° corner connection
- Included M6 or M8 set screws allow for easy installation
- Quick, easy connection for lightweight applications
- Required panel machining details on page 591

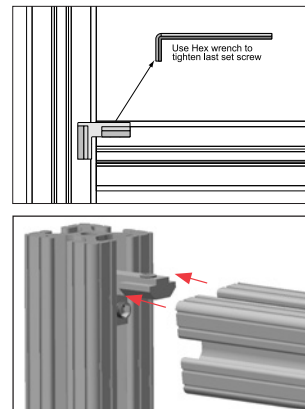
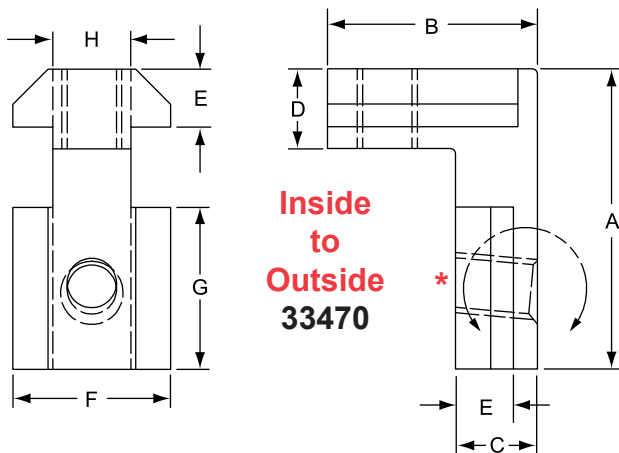
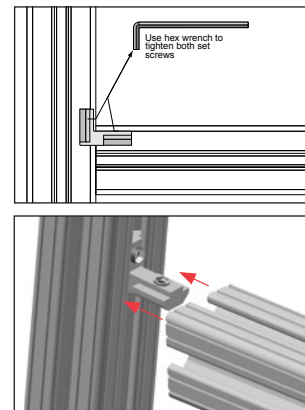
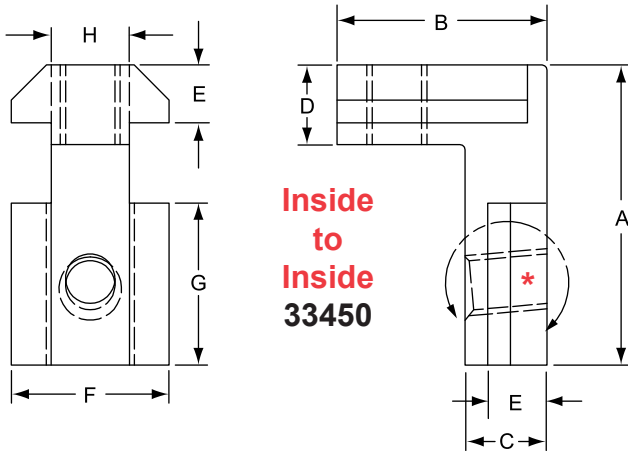
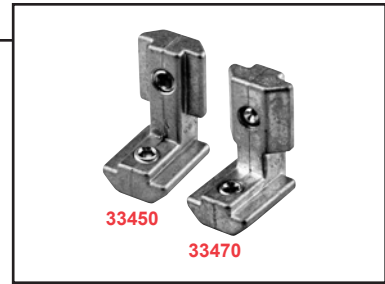

Part No.	Description	Slot	Set Screw Size	Wrench Size	A	B	C	D	E	F	G	H	Lbs.	Compatibility Code
33450	Inside to Inside	8mm	M6	3mm	1.181	.827	.323	.313	.228	.621	.638	.307	.050	8-15, 8-30, 8-40
33470	Inside to Outside	8mm	M6	3mm	1.181	.827	.323	.313	.228	.621	.638	.307	.100	

80/20® Inc.

The Industrial Erector Set®

THE STANDARD**Anchor Fasteners**

- One of 80/20®'s strongest fastening options
- Allows infinite positioning along a T-slotted profile
- Provides a vibration-proof, clean, flush connection where space restrictions apply
- Creates 90° connections where T-slots are in alignment
- Refer to page 567 for counterbore machining specifications
- Ships pre-assembled, saving you time *

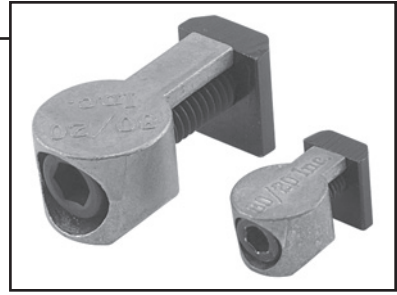

Part No.	Finish	Bolt Type	T-Nut Type	Lbs.
* 3395 ☒	Zinc Casting w/ Lacquer Finish	10-32 x.75"	Slide-In	.020
3896 ☒	Zinc Casting w/ Lacquer Finish	M5 x 18mm	Slide-In	.020
3363 ☒	Zinc Casting w/ Lacquer Finish	10-32 x.75"	Roll-In	.040
3665 ☒	Zinc Casting w/ Lacquer Finish	Stainless Steel 10-32 x.75"	Slide-In	.020
3391 ☒	Black Zinc Casting w/ Lacquer Finish	No bolt	N/A	.010
* 3392 ☒	Black Zinc Casting w/ Lacquer Finish	10-32 x.75"	Slide-In	.020
3396 ☒	Zinc Casting w/ Lacquer Finish	No Bolt	N/A	.010
* 3360	Zinc Casting w/ Lacquer Finish	5/16-18 x 1.3"	Slide-In	.100
3897	Zinc Casting w/ Lacquer Finish	M8 x 32mm	Slide-In	.100
3362	Zinc Casting w/ Lacquer Finish	5/16-18 x 1.3"	Roll-In	.100
3660	Zinc Casting w/ Lacquer Finish	Stainless Steel 5/16-18 x 1.25"	Slide-In	.100
3354	Black Zinc Casting w/ Lacquer Finish	No Bolt	N/A	.045
* 3359	Black Zinc Casting w/ Lacquer Finish	5/16-18 x 1.3"	Slide-In	.100
3361	Zinc Casting w/ Lacquer Finish	No Bolt	N/A	.045

☒ = 10 Series Compatible Part

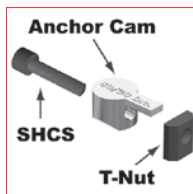
Anchor Fastener Assembly Steps**Step #1**

Anchor fasteners are composed of a socket head cap screw (SHCS), anchor cam and T-nut.

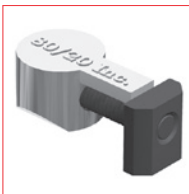
**Step #2**

Anchor fasteners ship pre-assembled. Slightly loosen the nut and bolt.

**Step #3**

Load the assembled anchor fastener into the counterbore hole. Be sure to position the T-nut with the offset hole oriented toward the top of the fastener. (See photo, Step #2)

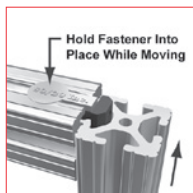
**Step #4**

While holding the anchor fastener in the counterbore hole, slide the mating profile into place.

**Step #5**

Square and align the mating profile. Using a T-handle hex wrench, tighten the SHCS in a clockwise motion until the profiles are securely affixed.

www.8020.net/anchor.asp

Fractional

Double Anchor Fasteners

- One of 80/20®'s strongest fastening options
- Allows infinite positioning along a T-slotted profile
- Provides a vibration-proof, clean, flush connection where space restrictions apply
- Creates 90° connections where T-slots are in alignment
- Profile must have T-slots opposite each other
- Short assemblies mount across the 1.0" dimension for 10 Series and 1.5" dimension for 15 Series
- Long assemblies mount across the 2.0" dimension for 10 Series and 3.0" dimension for 15 Series
- Refer to page 567 for counterbore machining specifications



Part No.	Finish	Bolt Assembly (Included)	Lbs.	Profile Compatibility
3090	Zinc Casting w/ Lacquer Finish	10-32 Short Assembly	.062	1010, 1003, 1004, 1020, 1030
3091	Zinc Casting w/ Black Finish	10-32 Short Assembly	.062	1010, 1003, 1004, 1020, 1030
3092	Zinc Casting w/ Lacquer Finish	10-32 Long Assembly	.080	1020, 2020, 2040
3093	Zinc Casting w/ Black Finish	10-32 Long Assembly	.080	1020, 2020, 2040
3094	Zinc Casting w/ Lacquer Finish	M5 Short Assembly	.062	1010, 1003, 1004, 1020, 1030
3096	Zinc Casting w/ Lacquer Finish	M5 Long Assembly	.080	1020, 2020, 2040
3098	Zinc Casting w/ Lacquer Finish	5/16-18 Short Assembly	.202	1515, 1515-Lite, 1503, 1504, 1530, 1530-Lite, 1545
3095	Zinc Casting w/ Black Finish	5/16-18 Short Assembly	.202	1515, 1515-Lite, 1503, 1504, 1530, 1530-Lite, 1545
3099	Zinc Casting w/ Lacquer Finish	5/16-18 Long Assembly	.263	1530, 1530-Lite, 3030, 3060
3097	Zinc Casting w/ Black Finish	5/16-18 Long Assembly	.263	1530, 1530-Lite, 3030, 3060
3100	Zinc Casting w/ Lacquer Finish	M8 Short Assembly	.202	1515, 1515-Lite, 1503, 1504, 1530, 1530-Lite, 1545
3102	Zinc Casting w/ Lacquer Finish	M8 Long Assembly	.263	1530, 1530-Lite, 3030, 3060

☒ = 10 Series Compatible Part

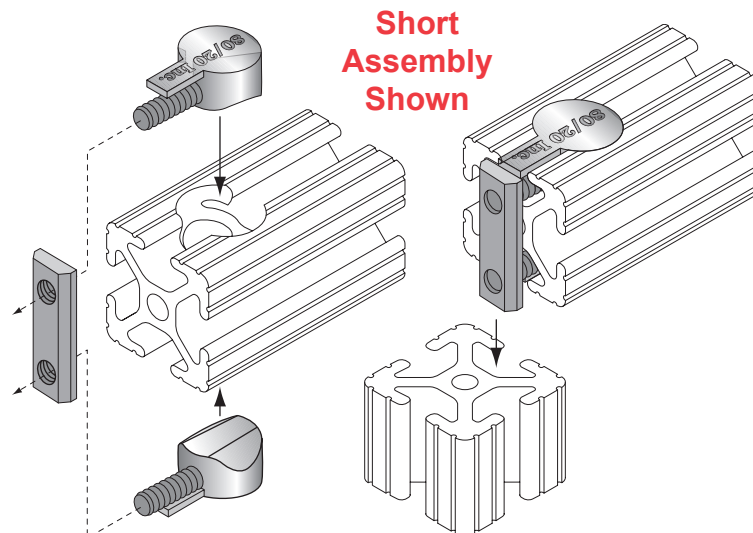

80/20® Inc.

The Industrial Erector Set®

THE STANDARD

Butt Fasteners

- Fastens two profiles end-to-end for maximum strength and near perfect alignment
- Connecting bolt included
- Provides a clean and flush connection where space restrictions apply
- Refer to page 567 for counterbore machining specifications

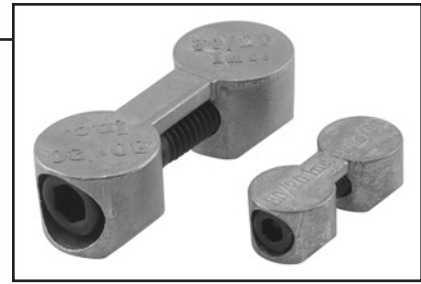
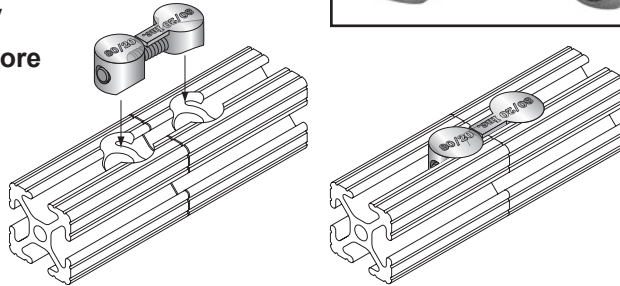

Part No.	Finish	Lbs.
3369 ☒	Zinc Casting w/ Lacquer Finish	.041
3370	Zinc Casting w/ Lacquer Finish	.145

☒ = 10 Series Compatible Part

3

Central Connector

Steel, Zinc-Plated

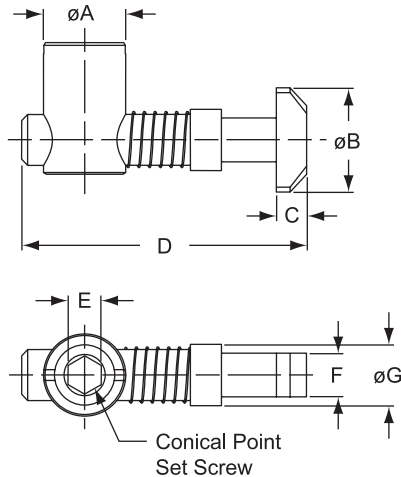

See page 581 for machining services.

Part No.	Connector Nut Orientation	A	B	C	D	E	F	G	Lbs.	Machining Service	Compatibility Code*
13187	Vertical	.590	.748	.216	2.047	.236	.315	.441	.110	7058	8-15, 8-40
13188	Horizontal							.433			

* See Compatibility Code information on page 152.

Fractional

Standard End Fasteners

- Provides a clean, hidden method of connecting profiles at 90° without the use of joining plates
- Winged tabs of clip prevents mating profile from rotating
- Mounting profile requires an end tap; mating profile requires an access hole to reach the screw head
- See page 564 for tapping services
- See page 565 for access hole services



Part No.	Finish	Screw Included	Thread	Lbs.
3381	Black Zinc	Yes	1/4-20	.020
3682	Bright Zinc (clip)	Yes (Stainless Steel)	1/4-20	.020
3895	Bright Zinc	Yes	M6 x 1.00	.020
3378	Black Zinc	No	N/A	.010
3681	Bright Zinc	No	N/A	.010
3380	Black Zinc	Yes	5/16-18	.048
3680	Bright Zinc (clip)	Yes (Stainless Steel)	5/16-18	.048
3891	Bright Zinc	Yes	M8 x 1.25	.048
3379	Black Zinc	No	N/A	.025
3679	Bright Zinc	No	N/A	.025

☒ = 10 Series Compatible Part

3

End Fastener Assembly Steps



Step #1
End fasteners are composed of a button head socket cap screw (BHSCS) and a wing clip.



Step #2
Pre-assemble by placing the BHSCS through the hole in the wing clip as shown in the photo at left.

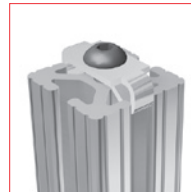

Step #3
Orient the wing clip in the direction of the mating profile's T-slot. Begin to screw the BHSCS into the tapped hole of the mounting profile. (Do NOT fully tighten)

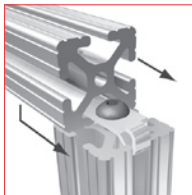

Step #4
Slide the mating profile into place. When aligned, the access hole on the mating profile should align with the BHSCS.

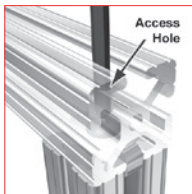

Step #5
Place a T-handle hex wrench into the access hole until the wrench head inserts into the BHSCS. Tighten clockwise until secure.



www.8020.net/end.asp

80/20® Inc.

The Industrial Erector Set®

THE STANDARD

Single Tab End Fasteners

- Provides a clean, hidden method of connecting closed-sided and quarter round profiles at 90° without the use of joining plates
- Winged tab of clip prevents mating profile from rotating
- The mounting profile requires an end tap; mating profile requires an access hole to reach the screw head
- See page 564 for tapping services
- See page 565 for access hole services



Part No.	Finish	Screw Included	Thread	Lbs.
3383 ☒	Black Zinc	Yes	1/4-20	.016
3183 ☒	Black Zinc	No	N/A	.005
3389	Black Zinc	Yes	5/16-18	.037
3189	Black Zinc	No	N/A	.014

☒ = 10 Series Compatible Part

3

Double End Fasteners

- Provides a clean, hidden method of connecting profiles at 90° without the use of joining plates
- Winged tabs of clip prevent mating profile from rotating
- Mounting profile requires an end tap; mating profile requires an access hole to reach the screw head
- See page 564 for tapping services
- See page 565 for access hole services



Part No.	Finish	Screw Included	Thread	Lbs.
3343 ☒	Black Zinc	Yes	1/4-20	.020
3792 ☒	Bright Zinc (clip)	Yes (Stainless Steel)	1/4-20	.020
3901 ☒	Bright Zinc	Yes	M6 x 1.00	.020
3351 ☒	Black Zinc	No	N/A	.010
3794 ☒	Bright Zinc	No	N/A	.010
3344	Black Zinc	Yes	5/16-18	.048
3793	Bright Zinc (clip)	Yes (Stainless Steel)	5/16-18	.048
3902	Bright Zinc	Yes	M8 x 1.25	.048
3352	Black Zinc	No	N/A	.025
3795	Bright Zinc	No	N/A	.025

☒ = 10 Series Compatible Part

Fractional

Miter Connector

- Strong, internal connector
- For use on square 15, 40 and 45 Series profiles
- Can be used in connection angles of 90° - 180°
- See page 579 for machining details

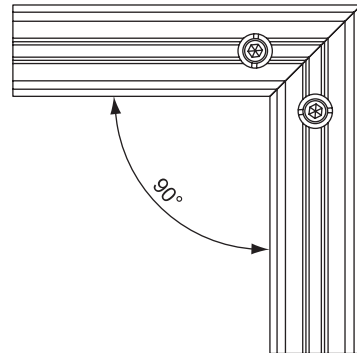
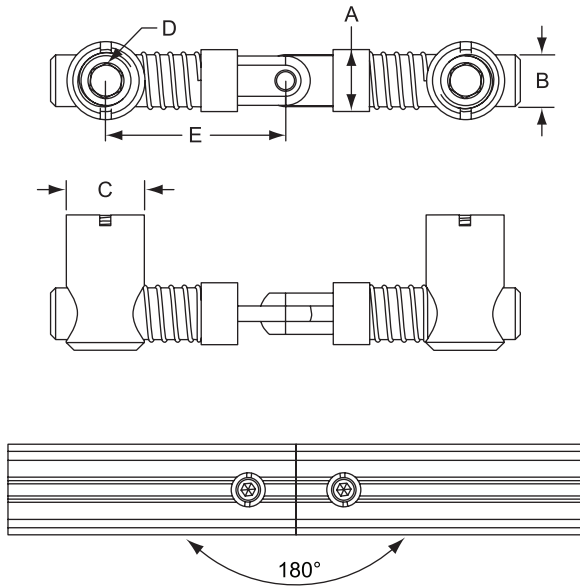
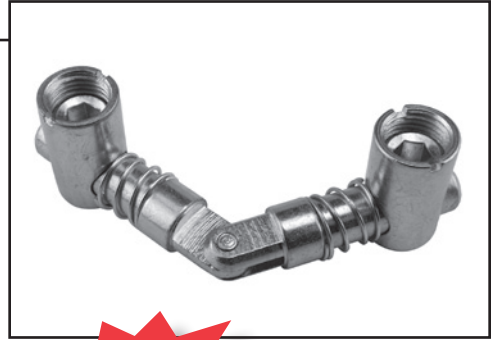

3

Part No.	A	B	C	D	E	Lbs.	Compatible Profiles
13193	.469	.394	.590	6mm Hex	1.307	.193	1515-UL, 1515-Lite, 1515, 1517, 1547, 1501, 1502, 1503, 1504, 1515-ULS, 1515-LS, 1515-S, 1517-LS, 1501-LS, 1502-LS, 1503-LS, 1504-LS, 40-4040-UL, 40-4040-Lite, 40-4040, 40-4001, 40-4002, 40-4003, 40-4004, 40-4030-Lite, 40-4045-Lite, 45-4545, 45-4545-Lite



80/20[®] Inc.

The Industrial Erector Set[®]

THE STANDARD

90° Inside Corner Connectors

- 15 and 40 Series compatible
- Provides a strong internal 90° corner connection
- Four 1/4-20 x 1/2" set screws included for mounting to T-slotted profiles
- No machining required
- 3364 is made from 6105-T5 aluminum stock and has no panel mount hole
- 3368 is made from die-cast zinc and has a 1/4-20 panel mount hole



3364

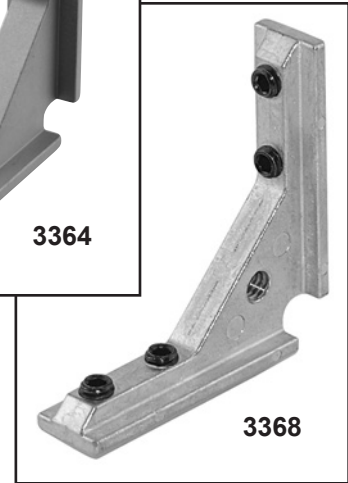

3368

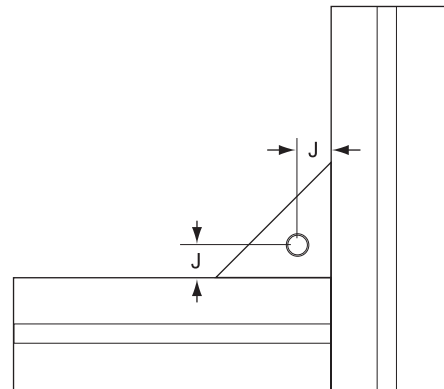
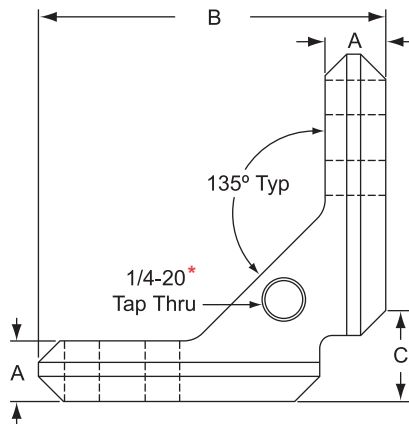
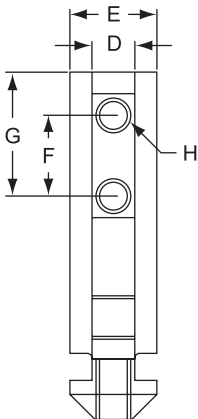

Part No.	Material	A	B	C	D	E	F	G	H	J	Lbs.
3364	Aluminum	.436	2.500	.475	.310	.625	.625	.962	1/4-20	N/A	.089
3368	Die-Cast Zinc	.436	2.500	.475	.310	.625	.625	.962	1/4-20	.294	.020

* Tap thru available only on 3368

Fractional Screws, Washers, & Nuts (Black Zinc)

Button Head Socket Cap Screws

Thread	Length	Lbs.	Part No.
8-32	3/8"	.002	3005
	1/2"	.003	3024
	7/8"	.005	3032
10-32	3/8"	.004	3042
	1/2"	.005	3050
	5/8"	.005	3051
1/4-20	3/4"	.006	3054
	3/8"	.007	3059
	1/2"	.008	3061
	5/8"	.010	3063
5/16-18	3/4"	.011	3065
	1/2"	.015	3104
	5/8"	.017	3111
	3/4"	.019	3114
	7/8"	.021	3117
	1"	.023	3118

Socket Head Cap Screws

Thread	Length	Lbs.	Part No.	
10-32	3/8"	.006	3044	
	1/2"	.006	3048	
	5/8"	.007	3052	
	3/4"	.008	3056	
	7/8"	.008	3057	
1/4-20	3/8"	.010	3058	
	1/2"	.011	3062	
	5/8"	.012	3067	
	3/4"	.014	3064	
	7/8"	.014	3068	
	1"	.016	3071	
	1 1/4"	.019	3072	
	1 1/2"	.022	3080	
	2 1/8"	.029	3081	
	2 1/2"	.033	3082	
	5/16-18	1/2"	.019	3106
		5/8"	.022	3110
3/4"		.024	3112	
7/8"		.026	3119	
1"		.028	3122	
1 1/4"		.032	3123	
1 1/2"		.036	3127	
1 3/4"		.040	3129	
2"		.044	3130	
2 1/4"		.048	3131	
3/8-16	2 1/2"	.052	3132	
	3"	.060	3133	
	3/4"	.037	3125	
1"	.043	3124		

Drop-In T-Slot Studs

Thread	Length	Lbs.	Part No.
5/16-18	3/4"	.023	3293
	1"	.027	3295
	1 1/4"	.032	3297
	1 1/2"	.036	3299

Flanged Button Head Socket Cap Screws

Thread	Length	Lbs.	Part No.
1/4-20	3/8"	.008	3390 ☒
	1/2"	.009	3342 ☒
	3/4"	.012	3066 ☒
5/16-18	1/2"	.016	3340
	11/16"	.019	3330

Slide-In Economy T-Slot Studs

Thread	Length	Lbs.	Part No.
5/16-18	3/4"	.026	3116
	1"	.031	3120
	1 1/4"	.035	3126
	1 1/2"	.039	3134
	1 3/4"	.045	3288
	2"	.050	3290

Flat Head Socket Cap Screws

Thread	Length	Lbs.	Part No.
10-32	1/2"	.006	3022
1/4-20	3/8"	.018	3012
	1/2"	.008	3400
	5/8"	.009	3405
	3/4"	.010	3406
5/16-18	1/2"	.018	3011
	5/8"	.016	3410
	3/4"	.018	3411
3/8-16	3/4"	.027	3420

Double Slide-In T-Nuts

Series-Length	Thread	Lbs.	Part No.
10 Series - 1.0"	10-32	.015	3085 ☒
10 Series - 2.0"	10-32	.034	3086 ☒
15 Series - 1.5"	5/16-18	.046	3087
15 Series - 3.0"	5/16-18	.105	3088

Slide-In Economy T-Nuts

Type	Thread	Lbs.	Part No.
Single	8-32	.008	3275 ☒
	10-32	.008	3276 ☒
	1/4-20	.012	3286
	1/4-20	.009	3382 ☒
	5/16-18	.021	3278
Double	5/16-18	.073	3279
	1/4-20	.023	3280 ☒
Triple	8-32	.019	3281 ☒
	5/16-18	.096	3285
	1/4-20	.030	3287 ☒

Low Head Socket Cap Screws

Thread	Length	Lbs.	Part No.
1/4-20	1"	.016	3017 ☒
5/16-18	1 1/4"	.035	3018

☒ = 10 Series Compatible Part

80/20® Inc.

The Industrial Erector Set®

THE STANDARD**Fractional Screws, Washers, & Nuts (Black Zinc) continued****Roll-In T-Nuts with Flex Handle**

Thread	Lbs.	Part No.
5/16-18	.023	3282
1/4-20	.024	3283
10-32	.026	3284
10-32	.009	3375 ☒
1/4-20	.008	3376 ☒

Roll-In T-Nuts with Set Screw

Thread	Lbs.	Part No.
10-32	.029	3309
1/4-20	.027	3310
5/16-18	.026	3311
10-32	.008	3312 ☒
1/4-20	.008	3313 ☒

Washers

Hole Size	Lbs.	Part No.
10-32	.005	3055
1/4	.004	3258
5/16	.005	3260
3/8	.006	3261

Hex Nuts

Thread	Lbs.	Part No.
10-32	.007	3053
1/4-20	.007	3208
5/16-18	.010	3214

Fractional Screws, Washers, & Nuts (Bright Zinc)**Slide-In Economy T-Slot Stud**

Thread	Length	Lbs.	Part No.
5/16-18	3/4"	.026	3716
	1"	.030	3720

Washers

Hole Size	Lbs.	Part No.
5/16	.005	3760
3/8	.018	3762
1/2	.036	3764

Hex Nuts

Thread	Lbs.	Part No.
5/16-18	.010	3714
3/8-24	.014	3707
1/2-13	.036	3709

Slide-In Economy T-Nuts

Thread	Lbs.	Part No.
1/4-20	.012	3786
5/16-18	.021	3778
1/4-20	.010	3785 ☒

Double Slide-In T-Nuts

Series-Length	Thread	Lbs.	Part No.
10 Series - 1.0"	M5	.015	3903 ☒
10 Series - 2.0"	M5	.034	3906 ☒
15 Series - 1.5"	M8	.046	3908
15 Series - 3.0"	M8	.105	3910

Roll-In T-Nuts with Flex Handle

Thread	Lbs.	Part No.
10-32	.026	3784
1/4-20	.025	3783
5/16-18	.023	3782
10-32	.009	3790 ☒
1/4-20	.009	3791 ☒

Roll-In T-Nuts with Set Screw

Thread	Lbs.	Part No.
10-32	.029	3781
1/4-20	.028	3787
5/16-18	.026	3788
M5 x 0.8	.029	3892
M6 x 1.0	.026	3898
M8 x 1.25	.025	3894

Roll-In T-Nuts with Ball Spring

Thread	Lbs.	Part No.
1/4-20	.028	3916
5/16-18	.026	3917
M5	.028	3913
M6	.026	3914
M8	.026	3915

☒ = 10 Series Compatible Part

Fractional

Fractional Screws, Washers, & Nuts (Bright Zinc) *continued*

5-16-18 Flanged Hex Head Threaded Bolts

Part No.	Length	Lbs.
3747	.50	.020
3748	.75	.024
3749	1.00	.028
3750	1.25	.032
3751	1.50	.036
3752	1.75	.039
3753	2.00	.041
3754	2.25	.043
3755	3.50	.050

5-16-18 BHSCS Threaded Bolts

Part No.	Length	Lbs.
3940	.50	.015
3941	.75	.019
3942	1.00	.023
3943	1.25	.031
3944	1.50	.038
3945	1.75	.045
3946	2.00	.053
3947	2.25	.061
3948	3.50	.102

5-16-18 SHCS Threaded Bolts

Part No.	Length	Lbs.
3950	.50	.020
3951	.75	.024
3952	1.00	.028
3953	1.25	.032
3954	1.50	.036
3955	1.75	.039
3956	2.00	.041
3957	2.25	.043
3958	3.50	.074

Stainless Steel Screws, Washers, & Nuts

Socket Head Cap Screws

Thread	Length	Lbs.	Part No.
10-32	3/8"	.005	3693
	1/2"	.006	3695
	5/8"	.007	3697
	3/4"	.008	3685
1/4-20	3/8"	.010	3687
	1/2"	.011	3689
	3/4"	.014	3691
5/16-18	1/2"	.020	3610
	5/8"	.022	3612
	3/4"	.024	3615
	7/8"	.026	3619
	1"	.028	3622
	1 1/4"	.032	3627

Button Head Socket Cap Screws

Thread	Length	Lbs.	Part No.
10-32	3/8"	.004	3694
	1/2"	.005	3696
	5/8"	.006	3698
1/4-20	3/8"	.007	3688
	1/2"	.008	3690
	5/8"	.010	3663
5/16-18	3/4"	.011	3692
	1/2"	.015	3609
	5/8"	.017	3611
	3/4"	.019	3614
	7/8"	.021	3617
	1"	.023	3621

Flat Head Socket Cap Screws

Thread	Length	Lbs.	Part No.
1/4-20	1/2"	.007	3645
1/4-20	5/8"	.009	3677

Roll-In T-Nuts with Flex Handle

Thread	Lbs.	Part No.
1/4-20	.008	3624 ☒
1/4-20	.022	3602
5/16-18	.023	3600

Roll-In T-Nuts with Set Screw

Thread	Lbs.	Part No.
1/4-20	.027	3605
5/16-18	.026	3608

Slide-In Economy T-Slot Studs

Thread	Length	Lbs.	Part No.
5/16-18	3/4"	.027	3616
	1"	.031	3623

Washers

Hole Size	Lbs.	Part No.
1/4	.003	3658
5/16	.005	3659

Hex Nuts

Thread	Lbs.	Part No.
1/4-20	.007	3656
5/16-18	.011	3657

Slide-In Economy T-Nuts

Thread	Lbs.	Part No.
10-32	.005	3676 ☒
1/4-20	.012	3686
5/16-18	.024	3678

☒ = 10 Series Compatible Part

80/20® Inc.

The Industrial Erector Set®

THE STANDARD**Metric Screws, Washers, & Nuts (Bright Zinc)****Button Head Socket Cap Screws**

Thread	Length	Lbs.	Part No.
M6	12mm	.007	3802
	16mm	.009	3804
	20mm	.011	3808
	25mm	.015	3809
M8	12mm	.015	3811
	16mm	.018	3813
	20mm	.020	3815
	25mm	.024	3819

Slide-In Economy T-Slot Studs

Thread	Length	Lbs.	Part No.
M8	20mm	.031	3851
	25mm	.034	3852
	30mm	.037	3853
	35mm	.043	3854
	45mm	.047	3857

Socket Head Cap Screws

Thread	Length	Lbs.	Part No.
M6	12mm	.011	3801
	16mm	.012	3803
	20mm	.013	3806
	25mm	.015	3807
M8	12mm	.023	3810
	16mm	.025	3812
	20mm	.027	3814
	25mm	.031	3818
	30mm	.035	3822

Hex Nuts

Thread	Lbs.	Part No.
M6	.005	3820
M8	.011	3821

Washers

Hole Size	Lbs.	Part No.
M6	.002	3861
M8	.004	3860

Roll-In T-Nuts with Flex Handle

Thread	Lbs.	Part No.
M5	.010	3875 ☒
M6	.008	3876 ☒
M6	.023	3843
M8	.023	3842

Slide-In Economy T-Nuts

Thread	Lbs.	Part No.
M6	.017	3836
M6	.010	3859 ☒
M8	.021	3838

☒ = 10 Series Compatible Part



**Button Head
Socket Cap
Screw (BHSCS)**



**Socket Head
Cap Screw
(SHCS)**



**Flat Head
Socket Cap
Screw (FHSCS)**



**Flanged Button
Head Socket
Cap Screw
(FBHSCS)**

Bolt Assemblies

Fractional (Black Zinc)

Thread	Screw Type	Length	Slide-In Econ T-Nut	Lbs.	Roll-In T-Nut	Lbs.	Hex Nut	Washer
8-32	BHSCS	3/8"	3483	.010	—	—	—	—
	BHSCS	1/2"	—	.016	—	—	3489	—
10-32	SHCS	3/8"	3457	.013	—	—	—	—
	SHCS, Washer	5/8"	—	.019	—	—	3459	—
1/4-20	BHSCS	1/2"	3487	.013	—	—	—	—
	FBHSCS	3/8"	3386	.017	3480	.016	—	—
	FBHSCS	1/2"	3321	.018	3481	.017	—	—
	FBHSCS	3/4"	3384	.020	3485	.040	—	—
	FBHSCS, Washer	3/4"	—	.023	—	—	3004	—
	BHSCS, Washer	1/2"	3398	.021	3399	.020	—	—
	BHSCS, Washer	5/8"	3482	.022	3484	.021	—	—
	BHSCS	5/8"	—	.013	—	—	—	3367
	BHSCS, Washer	3/4"	—	.022	—	—	3469	—
	SHCS	3/8"	3486	.019	3490	.018	—	—
	SHCS	1/2"	3491	.020	3492	.019	—	—
	SHCS	5/8"	3493	.021	3494	.020	—	—
	SHCS	3/4"	3304	.022	3397	.022	—	—
	SHCS	7/8"	3305	.024	—	—	—	—
	SHCS	1"	3306	.025	—	—	—	—
	SHCS	1 1/4"	3307	.028	—	—	—	—
	SHCS	1 1/2"	3308	.032	—	—	—	—
	SHCS, Washer	1/2"	3495	.024	3496	.023	—	—
	SHCS, Washer	5/8"	3497	.025	3498	.024	—	—
	BHSCS	1/2"	3393	.017	3394	.020	—	—
5/16-18	FBHSCS	1/2"	3319	.036	3318	.038	—	—
	FBHSCS	11/16"	3320	.039	3323	.041	—	—
	FBHSCS, Washer	5/8"	—	.045	—	—	3463	—
	BHSCS, Washer	5/8"	3435	.040	3437	.043	—	—
	BHSCS	5/8"	3365	.038	—	—	—	—
	BHSCS, Washer	3/4"	3439	.044	3441	.046	3442	—
	BHSCS	3/4"	—	.024	—	—	—	3366
	BHSCS, Washer	1"	3443	.041	3445	.043	—	—
	SHCS	1/2"	3450	.034	3452	.042	—	—
	SHCS	5/8"	3454	.042	3456	.044	—	—
	SHCS	3/4"	3455	.045	—	—	—	—
	SHCS	7/8"	3458	.046	3460	.049	—	—
	SHCS, Washer	5/8"	3462	.047	3464	.048	—	—
	SHCS, Washer	3/4"	3466	.049	3468	.051	—	—
	SHCS, Washer	7/8"	—	.036	—	—	3446	—
	SHCS, Washer	1"	3470	.053	3472	.054	—	—

80/20® Inc.

The Industrial Erector Set®

THE STANDARD**Bolt Assemblies** *continued***Fractional Slide-In Economy T-Slot Stud Assemblies (Black Zinc)**

Thread	Screw Type	Length	Hex Nut	Lbs.
5/16-18	T-Slot Stud, Washer	3/4"	3325	.041
		1"	3150	.045
		1 1/4"	3151	.050
		1 1/2"	3152	.054
		1 3/4"	3153	.059
		2"	3154	.065

Fractional Slide-In Economy T-Slot Stud Assemblies (Bright Zinc)

Thread	Screw Type	Length	Hex Nut	Lbs.
5/16-18	T-Slot Stud, Washer	3/4"	3745	.040
		1"	3737	.045

Fractional Slide-In Economy T-Slot Stud Assemblies (Stainless Steel)

Thread	Screw Type	Length	Hex Nut	Lbs.
5/16-18	T-Slot Stud, Washer	3/4"	3644	.038
		1"	3646	.042

Metric Cap Screw Assemblies (Bright Zinc)

Thread	Screw Type	Length	Slide-In Econ T-Nut	Lbs.	Roll-In T-Nut	Lbs.
M6	BHSCS, Washer	12mm	—	—	3824	.034
	BHSCS, Washer	16mm	—	—	3827	.034
	BHSCS, Washer	20mm	—	—	3850	.046
	BHSCS, Washer	25mm	—	—	3829	.048
	SHCS	12mm	—	—	3833	.036
	SHCS	20mm	—	—	3847	.037
	SHCS	25mm	—	—	3845	.039
	SHCS, Washer	12mm	—	—	3849	.037
	SHCS, Washer	16mm	—	—	3856	.038
M8	BHSCS	12mm	—	—	3867	.048
	BHSCS, Washer	16mm	3830	.040	3832	.042
	BHSCS, Washer	20mm	3870	.048	3872	.049
	BHSCS, Washer	25mm	3877	.050	3886	.051
	SHCS	12mm	3834	.043	3840	.045
	SHCS	16mm	3864	.045	3865	.048
	SHCS	20mm	—	—	3869	.050
	SHCS, Washer	16mm	3874	.050	3878	.051
	SHCS, Washer	20mm	3816	.052	3817	.054
SHCS, Washer	25mm	3887	.056	3888	.058	

Fractional Slide-In Economy T-Nut Assemblies (Black Zinc)

Thread	Screw Type	Length	Lbs.	Part No.
1/4-20	FHSCS	1/2"	.015	3414
5/16-18	FHSCS	5/8"	.035	3412

3

Bolt Assemblies continued

Fractional Cap Screw Assemblies (Stainless Steel)

Thread	Screw Type	Length	Lbs.	Econ T-Nut
1/4-20	BHSCS, Washer	5/8"	.024	3647
5/16-18	BHSCS, Washer	5/8"	.026	3620
	BHSCS, Washer	3/4"	.044	3630
	BHSCS, Washer	1"	.052	3632
	SHCS	1/2"	.044	3634
	SHCS	5/8"	.047	3636
	SHCS	7/8"	.050	3638
	SHCS, Washer	5/8"	.052	3699
	SHCS, Washer	3/4"	.053	3640
	SHCS, Washer	1"	.057	3642

Fractional Drop-In T-Slot Stud Assemblies (Black Zinc)

Thread	Screw Type	Length	Lbs.	Hex Nut
5/16-18	Drop-In Stud, Washer	3/4"	.023	3476
		1"	.027	3478
		1 1/4"	.032	3302
		1 1/2"	.036	3303

Metric Slide-In Economy T-Slot Stud Assemblies (Bright Zinc)

Thread	Screw Type	Length	Lbs.	Hex Nut
M8	T-Slot Stud, Washer	20mm	.046	3880
		25mm	.049	3881
		30mm	.052	3882
		35mm	.058	3883
		45mm	.062	3884

Double Slide-In T-Nut Assemblies (Black Zinc)

Thread	Screw Type	Length	Lbs.	Part No.
M8	BHSCS, Washers (2)	20mm	.092	3863
1/4-20	FBHSCS(2)	3/8"	.036	3002
1/4-20	FBHSCS(2)	1/2"	.038	3356
5/16-18	FBHSCS(2)	1/2"	.099	3000
5/16-18	FBHSCS(2)	11/16"	.100	3355

Roll-In T-Nut Assemblies (Black Zinc)

Thread	Screw Type	Length	Lbs.	Part No.
1/4-20	FHSCS	1/2"	.030	3415
5/16-18	FHSCS	5/8"	.040	3413

Triple Slide-In T-Nut Assemblies (Black Zinc)

Thread	Screw Type	Length	Lbs.	Part No.
1/4-20	FBHSCS(3)	1/2"	.062	3358
5/16-18	FBHSCS(3)	11/16"	.135	3357

80/20® Inc.

The Industrial Erector Set®

THE STANDARD**Bolt Assemblies** *continued***Numerical Listing**

Part No.	Series	Thread	Screw Type	Length	Nut Type	Washer	Finish
3000	15	5/16-18	FBHSCS (2)	1/2"	Double Slide-In Economy T-Nut	No	Black Zinc
3002	10	1/4-20	FBHSCS (2)	3/8"	Double Slide-In Economy T-Nut	No	Black Zinc
3004		1/4-20	FBHSCS	3/4"	Hex Nut	Yes	Black Zinc
3035	10	M6	SHCS	20mm	Slide-In Economy T-Nut	No	Blue
3150	15	5/16-18	Slide-In Econ T-Slot Stud	1"	Hex Nut	Yes	Black Zinc
3151	15	5/16-18	Slide-In Econ T-Slot Stud	1 1/4"	Hex Nut	Yes	Black Zinc
3152	15	5/16-18	Slide-In Econ T-Slot Stud	1 1/2"	Hex Nut	Yes	Black Zinc
3153	15	5/16-18	Slide-In Econ T-Slot Stud	1 3/4"	Hex Nut	Yes	Black Zinc
3154	15	5/16-18	Slide-In Econ T-Slot Stud	2"	Hex Nut	Yes	Black Zinc
3289		3/8-16	SHCS	1"	N/A	Yes	Black Zinc
3291		1/2-13	SHCS	1"	N/A	Yes	Black Zinc
3300	15	5/16-18	Roll-In T-Slot Stud	3/4"	Hex Nut	Yes	Black Zinc
3301	15	5/16-18	Roll-In T-Slot Stud	1"	Hex Nut	Yes	Black Zinc
3302	15	5/16-18	Roll-In T-Slot Stud	1 1/4"	Hex Nut	Yes	Black Zinc
3303	15	5/16-18	Roll-In T-Slot Stud	1 1/2"	Hex Nut	Yes	Black Zinc
3304	10	1/4-20	SHCS	3/4"	Slide-In Economy T-Nut	No	Black Zinc
3305	10	1/4-20	SHCS	7/8"	Slide-In Economy T-Nut	No	Black Zinc
3306	10	1/4-20	SHCS	1"	Slide-In Economy T-Nut	No	Black Zinc
3307	10	1/4-20	SHCS	1 1/4"	Slide-In Economy T-Nut	No	Black Zinc
3308	10	1/4-20	SHCS	1 1/2"	Slide-In Economy T-Nut	No	Black Zinc
3315		1/4-20	SHCS	7/8"	Hex Nut	Yes	Black Zinc
3318	15	5/16-18	FBHSCS	1/2"	Roll-In T-Nut	No	Black Zinc
3319	15	5/16-18	FBHSCS	1/2"	Slide-In Economy T-Nut	No	Black Zinc
3320	15	5/16-18	FBHSCS	11/16"	Slide-In Economy T-Nut	No	Black Zinc
3321	10	1/4-20	FBHSCS	1/2"	Slide-In Economy T-Nut	No	Black Zinc
3322	15	1/4-20	FBHSCS	1/2"	Roll-In T-Nut	No	Black Zinc
3323	15	5/16-18	FBHSCS	11/16"	Roll-In T-Nut	No	Black Zinc
3325	15	5/16-18	T-Slot Stud	3/4"	Hex Nut	Yes	Black Zinc
3355	15	5/16-18	FBHSCS (2)	11/16"	Double Slide-In Economy T-Nut	No	Black Zinc
3356	10	1/4-20	FBHSCS (2)	1/2"	Double Slide-In Economy T-Nut	No	Black Zinc
3357	15	5/16-18	FBHSCS (3)	11/16"	Triple Slide-In Economy T-Nut	No	Black Zinc
3358	10	1/4-20	FBHSCS (3)	1/2"	Triple Slide-In Economy T-Nut	No	Black Zinc
3365	15	5/16-18	BHSCS	5/8"	Slide-In Economy T-Nut	No	Black Zinc
3366		5/16-18	BHSCS	3/4"	N/A	Yes	Black Zinc
3367		1/4-20	BHSCS	5/8"	N/A	Yes	Black Zinc
3371	10	1/4-20	BHSCS	3/4"	Slide-In Econ. T-Nut	Yes	Black Zinc
3372	10	1/4-20	BHSCS	3/4"	Roll-In T-Nut	Yes	Black Zinc
3384	10	1/4-20	FBHSCS	3/4"	Slide-In Economy T-Nut	No	Black Zinc
3385	10	1/4-20	FBHSCS	3/4"	Roll-In T-Nut	No	Black Zinc
3386	10	1/4-20	FBHSCS	3/8"	Slide-In Economy T-Nut	No	Black Zinc
3387	10	1/4-20	FBHSCS	3/8"	Roll-In T-Nut	No	Black Zinc
3388		1/4-20	BHSCS	3/4"	none	Yes	Black Zinc
3393	10	1/4-20	BHSCS	1/2"	Slide-In Economy T-Nut	No	Black Zinc
3394	10	1/4-20	BHSCS	1/2"	Roll-In T-Nut	No	Black Zinc
3397	10	1/4-20	SHCS	3/4"	Roll-In T-Nut	No	Black Zinc
3398	10	1/4-20	BHSCS	1/2"	Slide-In Economy T-Nut	Yes	Black Zinc

Bolt Assemblies continued

Numerical Listing Continued

Part No.	Series	Thread	Screw Type	Length	Nut Type	Washer	Finish
3399	10	1/4-20	BHSCS	1/2"	Roll-In T-Nut	Yes	Black Zinc
3407	15	1/4-20	FHSCS	3/4"	Drop-In T-Nut	No	Zinc-Plated Steel
3408	15	1/4-20	BHSCS	1/2"	Drop-In T-Nut	No	Zinc-Plated Steel
3409	15	1/4-20	FHSCS	5/8"	Drop-In T-Nut	No	Zinc-Plated Steel
3412	15	5/16-18	FHSCS	5/8"	Slide-In Economy T-Nut	No	Black Zinc
3413	15	5/16-18	FHSCS	5/8"	Roll-In T-Nut	No	Black Zinc
3414	10	1/4-20	FHSCS	1/2"	Slide-In Economy T-Nut	No	Black Zinc
3415	10	1/4-20	FHSCS	1/2"	Roll-In T-Nut	No	Black Zinc
3416	10	1/4-20	BHSCS	3/8"	Slide-In Economy T-Nut	No	Black Zinc
3417		1/4-20	FHSCS	3/4"	Hex Nut	Yes	Black Zinc
3418	15	1/4-20	BHSCS	5/8"	Slide-In Economy T-Nut	No	Black Zinc
3419	10	1/4-20	SHCS	1/2"	Roll-In T-Nut	No	Black Zinc
3421	15	5/16-18	SHCS	1 1/4"	Slide-In Economy T-Nut	Yes	Black Zinc
3422	15	5/16-18	SHCS	1 1/2"	Slide-In Economy T-Nut	Yes	Black Zinc
3423	15	5-16-18	SHCS	1 3/4"	Slide-In Economy T-Nut	Yes	Black Zinc
3424	15	5/16-18	SHCS	2"	Slide-In Economy T-Nut	Yes	Black Zinc
3426	10	10-32	BHSCS	3/8"	Slide-In T-Nut	No	Black Zinc
3427	15	5/16-18	SHCS	2 1/4"	Slide-In Economy T-Nut	No	Black Zinc
3428	15	5/16-18	SHCS	2 1/2"	Slide-In Economy T-Nut	Yes	Black Zinc
3429	15	5/16-18	SHCS	2 1/2"	Slide-In Economy T-Nut	No	Black Zinc
3430	15	5/16-18	SHCS	3"	Slide-In Economy T-Nut	No	Black Zinc
3431	15	5/16-18	SHCS	3 1/4"	Slide-In Economy T-Nut	No	Black Zinc
3432	10	1/4-20	SHCS	1 1/2"	Slide-In Economy T-Nut	Yes	Black Zinc
3433	10	1/4-20	SHCS	2 1/8"	Slide-In Economy T-Nut	Yes	Black Zinc
3434	10	1/4-20	SHCS	2 1/2"	Slide-In Economy T-Nut	No	Black Zinc
3435	15	5/16-18	BHSCS	5/8"	Slide-In Economy T-Nut	Yes	Black Zinc
3436	15	5/16-18	BHSCS	1/2"	Slide-In Economy T-Nut	No	Black Zinc
3437	15	5/16-18	BHSCS	5/8"	Roll-In T-Nut	Yes	Black Zinc
3439	15	5/16-18	BHSCS	3/4"	Slide-In Economy T-Nut	Yes	Black Zinc
3441	15	5/16-18	BHSCS	3/4"	Roll-In T-Nut	Yes	Black Zinc
3442		5/16-18	BHSCS	3/4"	Hex Nut	Yes	Black Zinc
3443	15	5/16-18	BHSCS	1"	Slide-In Economy T-Nut	Yes	Black Zinc
3445	15	5/16-18	BHSCS	1"	Roll-In T-Nut	Yes	Black Zinc
3446		5/16-18	SHCS	7/8"	Hex Nut	Yes	Black Zinc
3450	15	5/16-18	SHCS	1/2"	Slide-In Economy T-Nut	No	Black Zinc
3452	15	5/16-18	SHCS	1/2"	Roll-In T-Nut	No	Black Zinc
3454	15	5/16-18	SHCS	5/8"	Slide-In Economy T-Nut	No	Black Zinc
3455	15	5/16-18	SHCS	3/4"	Slide-In Economy T-Nut	No	Black Zinc
3456	15	5/16-18	SHCS	5/8"	Roll-In T-Nut	No	Black Zinc
3457	10	10-32	SHCS	3/8"	Slide-In Economy T-Nut	No	Black Zinc
3458	15	5/16-18	SHCS	7/8"	Slide-In Economy T-Nut	No	Black Zinc
3459		10-32	SHCS	5/8"	Hex Nut	Yes	Black Zinc
3460	15	5/16-18	SHCS	7/8"	Roll-In T-Nut	No	Black Zinc
3461	15	5/16-18	BHSCS	5/8"	Slide-In Economy T-Nut	No	Black Zinc
3462	15	5/16-18	SHCS	5/8"	Slide-In Economy T-Nut	Yes	Black Zinc
3463		5/16-18	FBHSCS	11/16"	Hex Nut	Yes	Black Zinc

80/20® Inc.

The Industrial Erector Set®

THE STANDARD**Bolt Assemblies** *continued***Numerical Listing Continued**

Part No.	Series	Thread	Screw Type	Length	Nut Type	Washer	Finish
3464	15	5/16-18	SHCS	5/8"	Roll-In T-Nut	Yes	Black Zinc
3465		1/4-20	FBHSCS	1/2"	Hex Nut	No	Black Zinc
3466	15	5/16-18	SHCS	3/4"	Slide-In Economy T-Nut	Yes	Black Zinc
3467		5/16-18	BHSCS	3/4"	Hex Nut	Yes	Black Zinc
3468	15	5/16-18	SHCS	3/4"	Roll-In T-Nut	Yes	Black Zinc
3469		1/4-20	BHSCS	3/4"	Hex Nut	Yes	Black Zinc
3470	15	5/16-18	SHCS	1"	Slide-In Economy T-Nut	Yes	Black Zinc
3471	10	1/4-20	SHCS	7/8"	Slide-In Economy T-Nut	Yes	Black Zinc
3472	15	5/16-18	SHCS	1"	Roll-In T-Nut	Yes	Black Zinc
3473		5/16-18	SHCS	1"	Hex Nut	Yes	Black Zinc
3474		5/16-18	Slide-In Economy T-Slot Stud	1"	Hex Nut	Yes	Black Zinc
3475	15	5/16-18	SHCS	1 1/2"	Slide-In Economy T-Nut	No	Black Zinc
3476		5/16-18	Roll-In T Stud	3/4"	Hex Nut	Yes	Black Zinc
3478		5/16-18	Roll-In T Stud	1"	Hex Nut	Yes	Black Zinc
3479	10	1/4-20	BHSCS	3/4"	Slide-In T-Nut	No	Black Zinc
3480	10	1/4-20	FBHSCS	3/8"	Roll-In T-Nut	No	Black Zinc
3481	10	1/4-20	FBHSCS	1/2"	Roll-In T-Nut	No	Black Zinc
3482	10	1/4-20	BHSCS	5/8"	Slide-In Economy T-Nut	Yes	Black Zinc
3483	10	8-32	BHSCS	3/8"	Slide-In Economy T-Nut	No	Black Zinc
3484	10	1/4-20	BHSCS	5/8"	Roll-In T-Nut	Yes	Black Zinc
3485	10	1/4-20	FBHSCS	3/4"	Roll-In T-Nut	No	Black Zinc
3486	10	1/4-20	SHCS	3/8"	Slide-In Economy T-Nut	No	Black Zinc
3487	15	10-32	BHSCS	1/2"	Slide-In T-Nut	No	Black Zinc
3488		10-32	BHSCS	5/8"	Hex Nut	Yes	Black Zinc
3489		8-32	BHSCS	1/2"	Hex Nut	Yes	Black Zinc
3490	10	1/4-20	SHCS	3/8"	Roll-In T-Nut	No	Black Zinc
3491	10	1/4-20	SHCS	1/2"	Slide-In Economy T-Nut	No	Black Zinc
3492	10	1/4-20	SHCS	1/2"	Roll-In T-Nut	No	Black Zinc
3493	10	1/4-20	SHCS	5/8"	Slide-In Economy T-Nut	No	Black Zinc
3494	10	1/4-20	SHCS	5/8"	Roll-In T-Nut	No	Black Zinc
3495	10	1/4-20	SHCS	1/2"	Slide-In Economy T-Nut	Yes	Black Zinc
3496	10	1/4-20	SHCS	1/2"	Roll-In T-Nut	Yes	Black Zinc
3497	10	1/4-20	SHCS	5/8"	Slide-In Economy T-Nut	Yes	Black Zinc
3498	10	1/4-20	SHCS	5/8"	Roll-In T-Nut	Yes	Black Zinc
3499		5/16-18	BHSCS	7/8"	none	Yes	Black Zinc
3618	15	5/16-18	BHSCS	5/8"	Roll-In T-Nut	Yes	Stainless Steel
3620	15	5/16-18	BHSCS	5/8"	Slide-In Economy T-Nut	Yes	Stainless Steel
3630	15	5/16-18	BHSCS	3/4"	Slide-In Economy T-Nut	Yes	Stainless Steel
3632	15	5/16-18	BHSCS	1"	Slide-In Economy T-Nut	Yes	Stainless Steel
3634	15	5/16-18	SHCS	1/2"	Slide-In Economy T-Nut	No	Stainless Steel
3636	15	5/16-18	SHCS	5/8"	Slide-In Economy T-Nut	No	Stainless Steel
3638	15	5/16-18	SHCS	7/8"	Slide-In Economy T-Nut	No	Stainless Steel
3639	10	1/4-20	FHSCS	1/2"	Roll-In T-Nut	No	Stainless Steel
3640	15	5/16-18	SHCS	3/4"	Slide-In Economy T-Nut	Yes	Stainless Steel
3642	15	5/16-18	SHCS	1"	Slide-In Economy T-Nut	Yes	Stainless Steel
3644		5/16-18	Slide-In Economy T-Slot Stud	3/4"	Hex Nut	Yes	Stainless Steel
3646		5/16-18	Slide-In Economy T-Slot Stud	1"	Hex Nut	Yes	Stainless Steel
3647	15	1/4-20	BHSCS	5/8"	Slide-In Economy T-Nut	Yes	Stainless Steel

Bolt Assemblies continued

Numerical Listing Continued

Part No.	Series	Thread	Screw Type	Length	Nut Type	Washer	Finish
3648	10	1/4-20	FHSCS	5/8"	Roll-In T-Nut	No	Stainless Steel
3699	15	5/16-18	SHCS	5/8"	Slide-In Economy T-Nut	Yes	Stainless Steel
3737		5/16-18	Slide-In Economy T-Slot Stud	1"	Hex Nut	Yes	Black Zinc
3745		5/16-18	Slide-In Economy T-Slot Stud	3/4"	Hex Nut	Yes	Black Zinc
3816	15	M8	SHCS	20mm	Slide-In Economy T-Nut	Yes	Bright Zinc
3817	15	M8	SHCS	20mm	Roll-In T-Nut	Yes	Bright Zinc
3824	10	M6	BHSCS	12mm	Roll-In T-Nut	Yes	Bright Zinc
3825		M8	Slide-In Economy T-Slot Stud	20mm	Hex Nut	Yes	Black Zinc
3826	15	M6	BHSCS	16mm	Slide-In Economy T-Nut	Yes	Black Zinc
3827	10	M6	BHSCS	16mm	Roll-In T-Nut	Yes	Bright Zinc
3829	10	M6	BHSCS	25mm	Roll-In T-Nut	Yes	Bright Zinc
3830	15	M8	BHSCS	16mm	Slide-In Economy T-Nut	Yes	Bright Zinc
3831	15	M6	SHCS	12mm	Slide-In Economy T-Nut	No	Black Zinc
3832	15	M8	BHSCS	16mm	Roll-In T-Nut	Yes	Bright Zinc
3833	10	M6	SHCS	12mm	Roll-In T-Nut	No	Bright Zinc
3834	15	M8	SHCS	12mm	Slide-In Economy T-Nut	No	Bright Zinc
3835	15	M6	SHCS	16mm	Roll-In T-Nut	No	Black Zinc
3840	15	M8	SHCS	12mm	Roll-In T-Nut	No	Bright Zinc
3841	15	M6	SHCS	25mm	Slide-In Economy T-Nut	No	Black Zinc
3845	10	M6	SHCS	25mm	Roll-In T-Nut	No	Bright Zinc
3847	10	M6	SHCS	20mm	Roll-In T-Nut	No	Bright Zinc
3849	10	M6	SHCS	12mm	Roll-In T-Nut	Yes	Bright Zinc
3850	10	M6	BHSCS	20mm	Roll-In T-Nut	Yes	Bright Zinc
3855	10	M6	SHCS	20mm	Roll-In T-Nut	Yes	Black Zinc
3856	10	M6	SHCS	16mm	Roll-In T-Nut	Yes	Bright Zinc
3862	10	M6	SHCS	25mm	Roll-In T-Nut	Yes	Black Zinc
3863	15	M8	BHSCS (2)	20mm	Double Slide-In Economy T-Nut	Yes (2)	Black Zinc
3864	15	M8	SHCS	16mm	Slide-In Economy T-Nut	No	Bright Zinc
3865	15	M8	SHCS	16mm	Roll-In T-Nut	No	Bright Zinc
3867	10	M6	BHSCS	12mm	Roll-In T-Nut	No	Bright Zinc
3869	15	M8	SHCS	20mm	Roll-In T-Nut	No	Bright Zinc
3870	15	M8	BHSCS	20mm	Slide-In Economy T-Nut	Yes	Bright Zinc
3872	15	M8	BHSCS	20mm	Roll-In T-Nut	Yes	Bright Zinc
3874	15	M8	SHCS	16mm	Slide-In Economy T-Nut	Yes	Bright Zinc
3877	15	M8	BHSCS	25mm	Slide-In Economy T-Nut	Yes	Bright Zinc
3878	15	M8	SHCS	16mm	Roll-In T-Nut	Yes	Bright Zinc
3880		M8	Slide-In Economy T-Slot Stud	20mm	Hex Nut	Yes	Bright Zinc
3881		M8	Slide-In Economy T-Slot Stud	25mm	Hex Nut	Yes	Bright Zinc
3882		M8	Slide-In Economy T-Slot Stud	30mm	Hex Nut	Yes	Bright Zinc
3883		M8	Slide-In Economy T-Slot Stud	35mm	Hex Nut	Yes	Bright Zinc
3884		M8	Slide-In Economy T-Slot Stud	45mm	Hex Nut	Yes	Bright Zinc
3885		M8	Slide-In Economy T-Slot Stud	50mm	Hex Nut	Yes	Bright Zinc
3886	15	M8	BHSCS	25mm	Roll-In T-Nut	Yes	Bright Zinc
3887	15	M8	SHCS	25mm	Slide-In Economy T-Nut	Yes	Bright Zinc
3888	15	M8	SHCS	25mm	Roll-In T-Nut	Yes	Bright Zinc
3889		M8	Slide-In Economy T-Slot Stud	20mm	Hex Nut	Yes	Bright Zinc
3890		M8	Slide-In Economy T-Slot Stud	30mm	Hex Nut	Yes	Bright Zinc
3899	15	M8	SHCS	20mm	Slide-In Economy T-Nut	No	Bright Zinc

80/20® Inc.*The Industrial Erector Set®***THE STANDARD****Ergonomic Workstations by 80/20®**

- Easily add ergonomic adjustability by incorporating 80/20®'s own Linear Bearings into your design.
- Mobile, adjustable and well-lit workstations that will fit almost any industrial need!
- Need hydraulic or pneumatic power? It's easy with 80/20® – using our profiles as an easy-to-attach manifold . . . even if it's an afterthought, it will appear to be part of your original design!
- Log on to www.8020.net and click **Downloads & Links** to get your FREE copy of AutoQuoterX™, 80/20®'s design software.

